

## Understanding our Drawings

We have prepared three sets of drawings to help you understand our proposals presented at this consultation and how you may be affected by them. These sets of drawings are:

- Temporary Plan Drawings – Drawing series 133735-MWJ-Z0-XXX-DRG-CSE-000100
- Permanent Plan Drawings – Drawing series 133735-MWJ-Z0-XXX-DRG-CSE-000101
- Permanent Plan and Profile Drawings – Drawing series 133735-MWJ-Z0-XXX-DRG-CSE-000102

For each route section from Oxford to Cambridge, these drawings show the boundary of our proposed works (the Draft Order Limits) and the type of works proposed in each area. The boundary of our proposed works includes our infrastructure proposals, indicative environmental mitigation such as tree planting and habitat improvement works as well as land that would be used temporarily for construction.

Our Permanent Plan and Profile drawings also show the proposed height (vertical alignment) of our proposals.

These drawings should be read in conjunction with our consultation document which describe our proposals.

## What is shown on the Drawings

The Drawings show the boundary of our proposed works at this consultation. This includes land for new infrastructure, works to existing infrastructure and associated mitigation works including environmental mitigation as well as land that would be used temporarily for construction.

The Permanent Plan Drawings and Plan and Profile Drawings includes our proposals for:

- Track alignment including earthworks, bridges, viaducts and tunnels
- Highway works
- Drainage ponds to support the above
- Proposed station locations and indicative layouts
- Indicative large rail system assets including traction power compounds and telecom compounds (smaller rail system assets are not shown but are assumed to fit within the proposed railway corridor)
- Public Rights of Way (PRoW), including where existing PRoWs are being closed/diverted
- Active travel routes
- Access including railway maintenance access and access for landowners to their retained land
- Preliminary environmental mitigation proposals

The Temporary Plan Drawings show our proposals for:

- Main compounds
- Satellite compounds
- Stock pile locations,
- Service roads
- Major utility diversions
- Access and working areas needed to construct the permanent works

## How our proposals will develop

The proposals at this consultation are based on preliminary designs to give you a general understanding of our proposals and to help inform feedback to the consultation. Your feedback, along with the results of further technical assessments, environmental impact assessment and mitigation proposals, will help us refine our proposals further before we submit our DCO application.

## Other Points of Note

- All dimensions are in metres.
- Background OS mapping from 2021.
- Connection Stage 1 (CS1) between Gavray Junction and Bletchley has only recently completed construction so background mapping does not yet reflect as-built records
- The proposals shown are illustrative only for consultation purposes only and will be subject to change as part of design development and could require minor amendments to the Draft Order Limits.
- This map is provided as a visual reference. Due to its complexity, it may not be fully accessible to all users.

## How you can use the Drawings

An example of a Plan and Profile drawing is shown below with an explanation to help you use the drawings. The same principles apply to all three sets of drawings. The numerical labels ① on the drawing correspond to the explanation below.

Our proposals are split into 8 route sections as indicated on the Drawing Map Index - 133735-MWJ-Z0-XXX-DRG-CSE-000097, 133735-MWJ-Z0-XXX-DRG-CSE-000098 and 133735-MWJ-Z0-XXX-DRG-CSE-000099. Each route section is given a different number, and within this each sheet is numbered ①.

The distance along the route section is shown using a bespoke chainage system ②. All chainages increase in a west to east direction with the first digit corresponding to the route section. For example Route Section 1 chainage starts at 100+000 and Route Section 2 chainage starts at 200+000. The distance between each chainage marker is 500 metres on the Plan drawings and 100 metres on the Plan and Profile drawings.

Each drawing shows a Plan of the area in question ③. For the Plan and Profiles we also show a profile for the same area as shown below ④. The Profile is the proposed vertical alignment of the railway relative to existing ground (to make level differences clearer to see the vertical scale is exaggerated by 10 times).

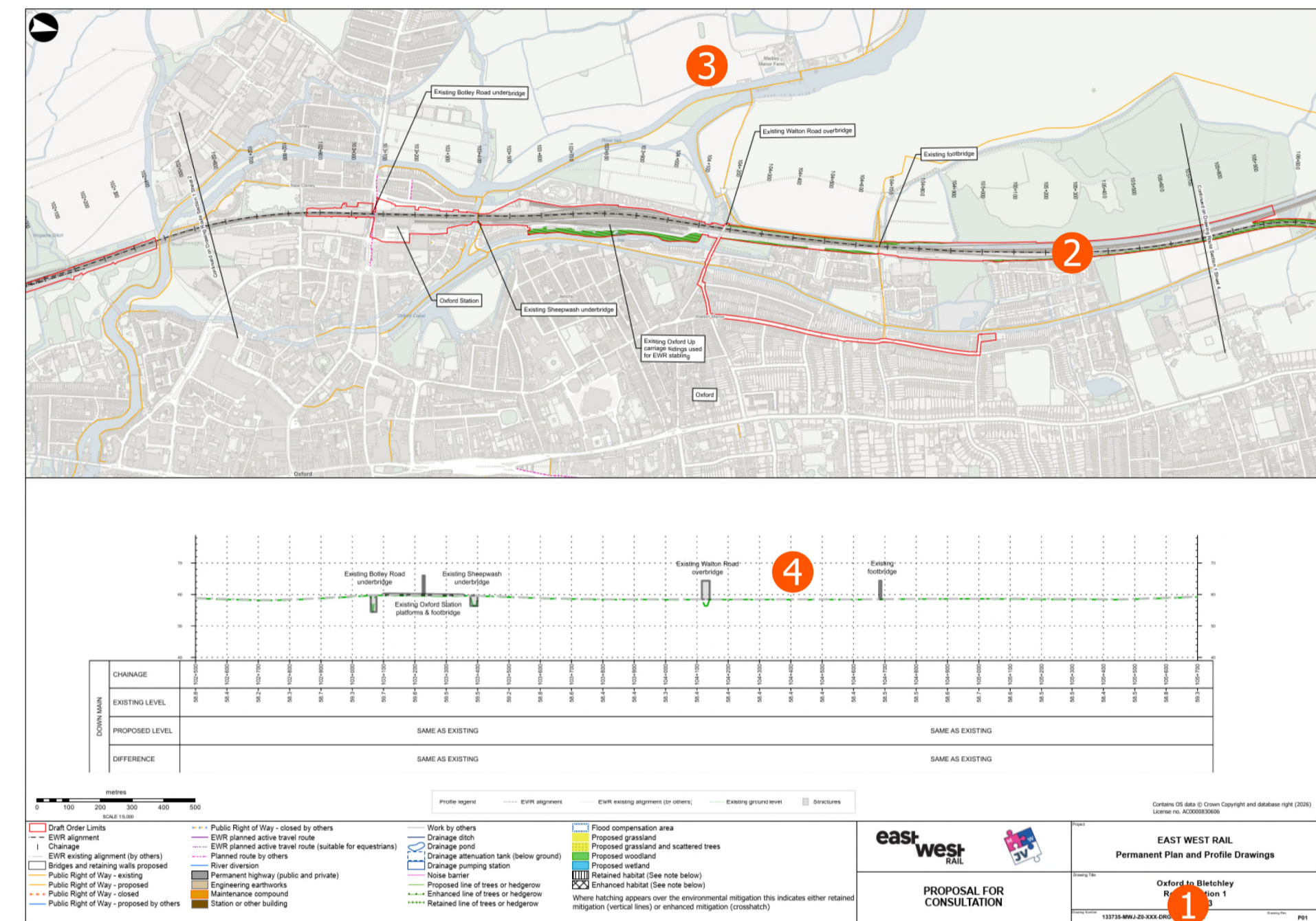

## Status of the Drawings

Based on ongoing design work and feedback gathered this consultation, we will further refine our proposals and define the limits in which permanent works can be constructed. These are typically known as Limits of Deviation. Limits of Deviation help provide us with the necessary flexibility to avoid unforeseen issues. This includes engineering or environmental issues that were not known at the time of the DCO application. For temporary works, such as construction activities, mitigation works or planting works, these are not subject to Limits of Deviation, but can only take place within the Draft Order Limits.

## Legend Extract

An extract is provided below which indicates which assets are shown on the Plan and Profiles and Permanent Plans.

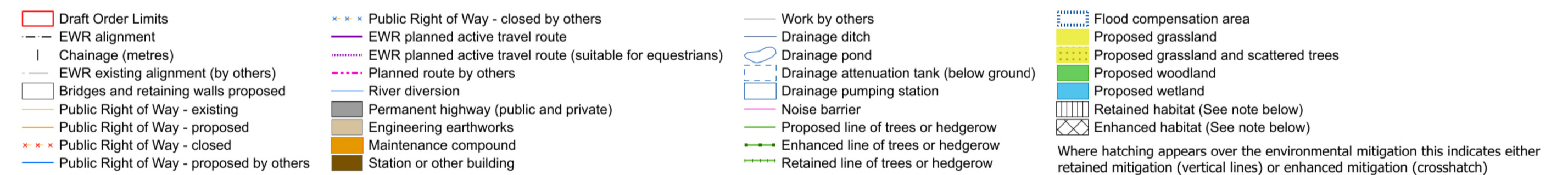

An extract is provided below which indicates which assets are shown on the Temporary Plans.

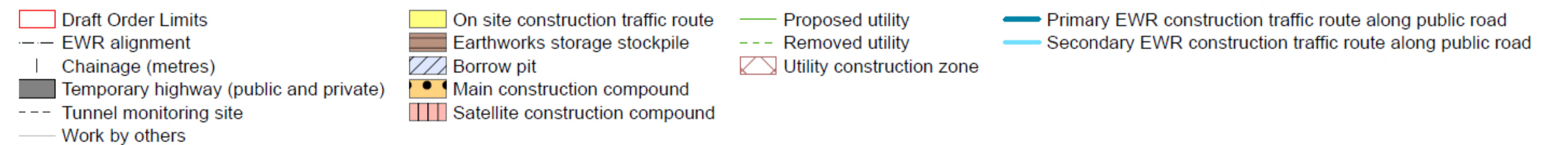

PROPOSAL FOR CONSULTATION

EAST WEST RAIL  
Plan and Profile

Oxford to Cambridge  
Guide to the drawings

Drawing Number 133735-MWJ-Z0-XXX-DRG-CSE-000096

Drawing Rev P02

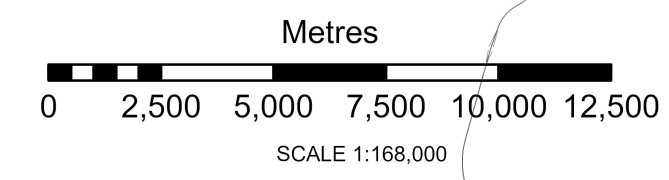
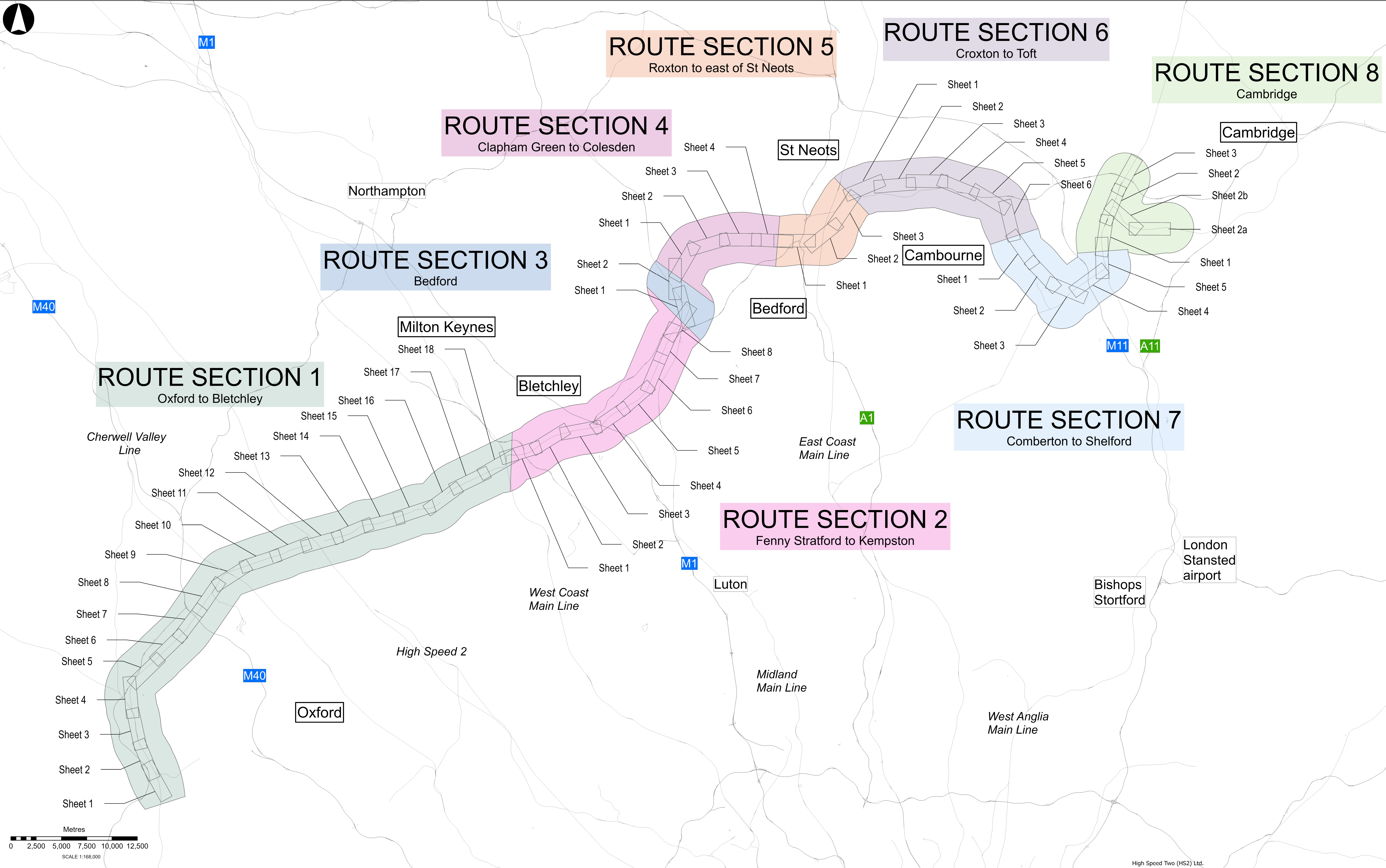
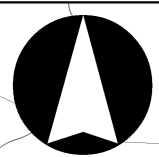

High Speed Two (HS2) Ltd.



Project  
**EAST WEST RAIL**

**PROPOSAL FOR CONSULTATION**

**Plan and Profile Map Index**

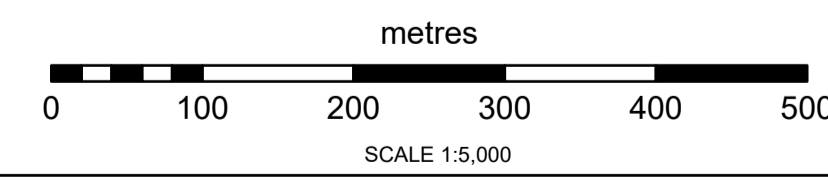
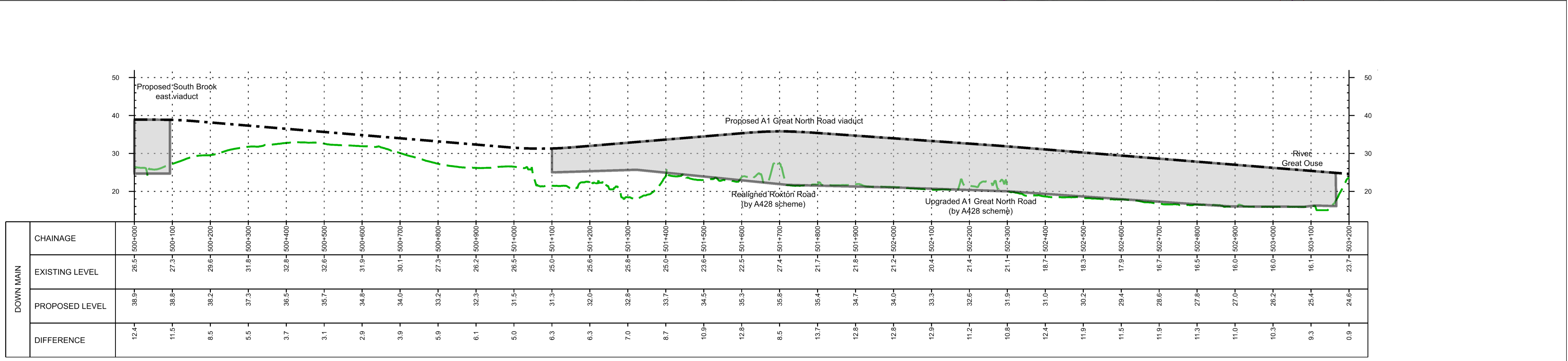
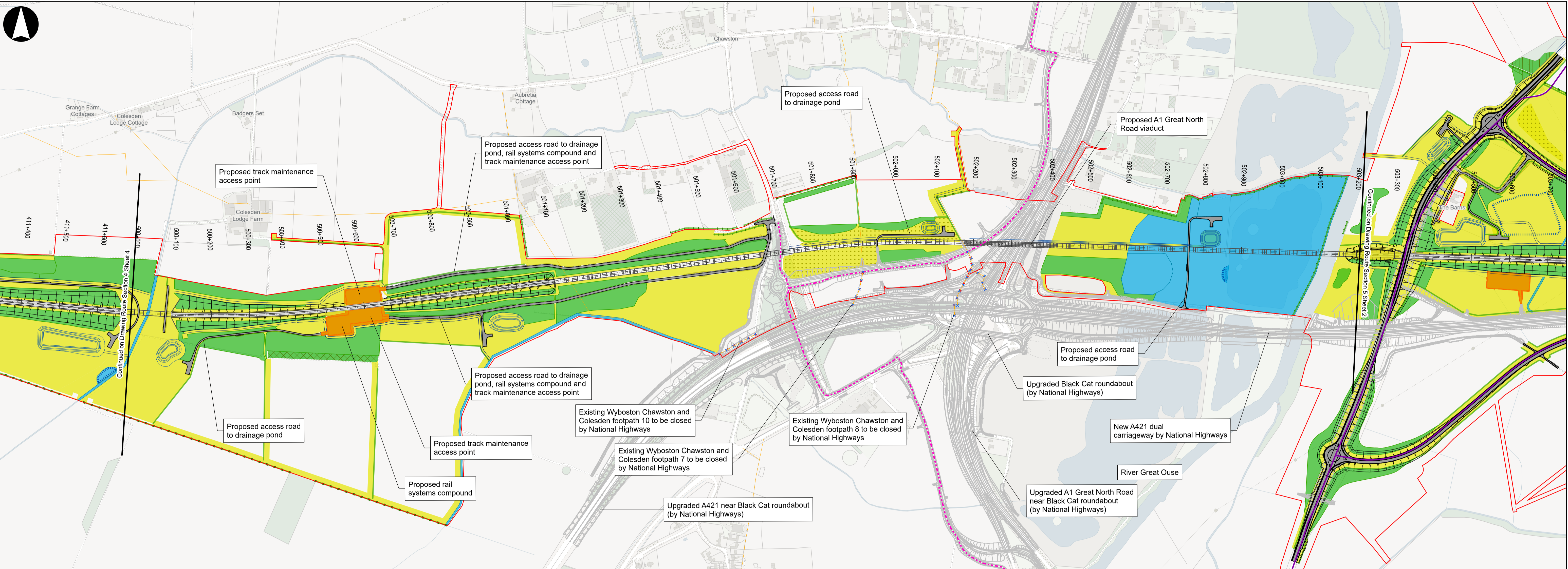

- Profile legend**
- EWR alignment
  - EWR existing alignment (by others)
  - Existing ground level
  - █ Structures
- Draft Order Limits
  - EWR alignment
  - Chainage
  - EWR existing alignment (by others)
  - █ Bridges and retaining walls proposed
  - Public Right of Way - existing
  - Public Right of Way - proposed
  - Public Right of Way - closed
  - Public Right of Way - proposed by others
  - Public Right of Way - closed by others
  - EWR planned active travel route
  - EWR planned active travel route (suitable for equestrians)
  - Planned route by others
  - River diversion
  - █ Permanent highway (public and private)
  - █ Engineering earthworks
  - █ Maintenance compound
  - █ Station or other building
  - Work by others
  - Drainage ditch
  - Drainage pond
  - Drainage attenuation tank (below ground)
  - Drainage pumping station
  - Noise barrier
  - Proposed line of trees or hedgerow
  - Enhanced line of trees or hedgerow
  - Retained line of trees or hedgerow
  - █ Flood compensation area
  - █ Proposed grassland
  - █ Proposed grassland and scattered trees
  - █ Proposed woodland
  - █ Proposed wetland
  - █ Retained habitat (See note below)
  - █ Enhanced habitat (See note below)
- Where hatching appears over the environmental mitigation this indicates either retained mitigation (vertical lines) or enhanced mitigation (crosshatch)

**east west RAIL**

**PROPOSAL FOR CONSULTATION**

Project  
**EAST WEST RAIL**  
Permanent Plan and Profile Drawings

Drawing Title  
**Roxton to east of St Neots**  
Route Section 5  
Sheet 01

Drawing Number  
133735-MWJ-Z0-XXX-DRG-CSE-000102

Drawing Rev  
P02

Contains OS data © Crown Copyright and database right (2026)  
License no. AC0000830606

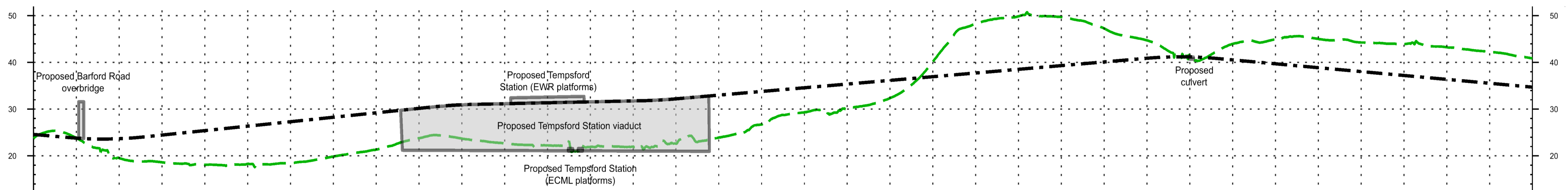
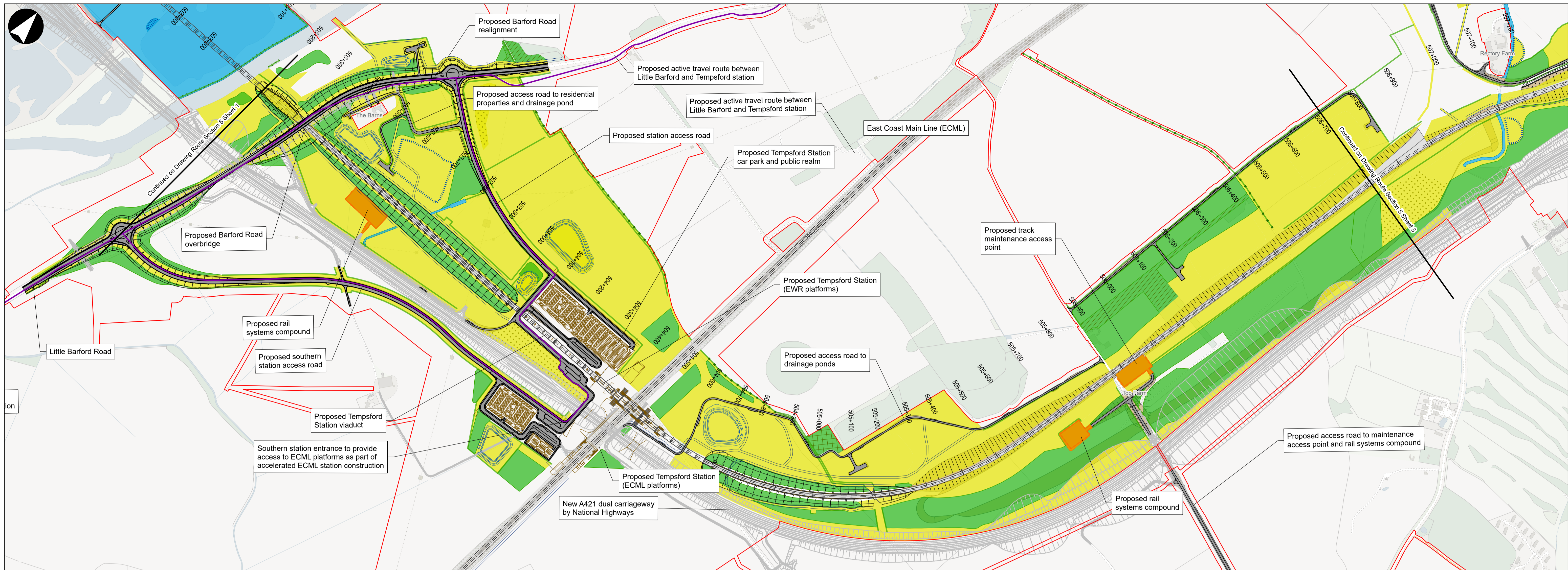

DOWN MAIN	CHAINAGE	237+503+200	238+503+300	19.5+503+400	18.6+503+500	18.1+503+600	18.3+503+700	18.5+503+800	19.9+503+900	21.3+504+000	23.8+504+100	23.7+504+200	22.7+504+300	22.2+504+400	22.2+504+500	21.9+504+600	22.5+504+700	24.0+504+800	25.9+504+900	27.8+505+000	30.1+505+100	32.4+505+200	40.2+505+300	48.3+505+400	49.9+505+500	49.7+505+600	47.3+505+700	44.8+505+800	40.7+505+900	44.0+506+000	44.9+506+100	45.1+506+200	44.3+506+300	43.9+506+400	43.3+506+500	42.3+506+600	40.9+506+700
	EXISTING LEVEL		23.7	23.8	19.5	18.6	18.1	18.3	18.5	19.9	21.3	23.8	23.7	22.7	22.2	22.2	21.9	22.5	24.0	25.9	27.8	30.1	32.4	40.2	48.3	49.9	49.7	47.3	44.8	40.7	44.0	44.9	45.1	44.3	43.9	43.3	42.3
PROPOSED LEVEL		24.6	23.8	23.7	24.5	25.4	26.4	27.3	28.3	29.2	30.2	31.0	31.2	31.4	31.6	31.8	32.2	33.0	33.8	34.6	35.4	36.2	36.9	37.7	38.5	39.3	40.1	40.9	41.2	40.5	39.7	38.9	38.0	37.2	36.4	35.5	34.7
DIFFERENCE		0.9	0.0	4.1	5.8	7.3	8.1	8.8	8.4	7.9	6.4	7.2	8.5	9.1	9.4	9.8	9.7	9.0	7.9	6.8	5.3	3.8	-3.3	-10.5	-11.3	-10.4	-7.2	-3.9	0.4	-3.4	-5.2	-6.2	-6.3	-6.7	-6.9	-6.7	-6.2

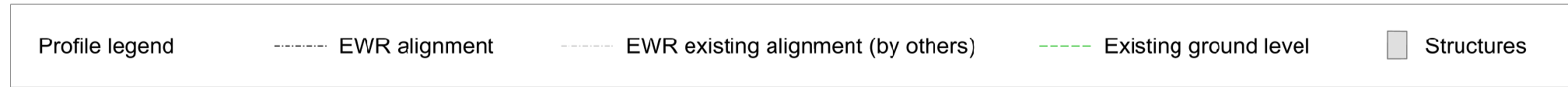
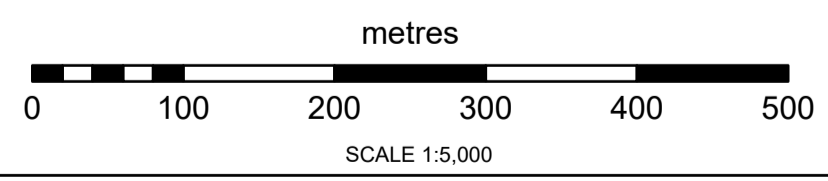

- Draft Order Limits
- EWR alignment
- Chainage
- EWR existing alignment (by others)
- Bridges and retaining walls proposed
- Public Right of Way - existing
- Public Right of Way - proposed
- Public Right of Way - closed
- Public Right of Way - proposed by others
- Public Right of Way - closed by others
- EWR planned active travel route
- EWR planned active travel route (suitable for equestrians)
- Planned route by others
- River diversion
- Permanent highway (public and private)
- Engineering earthworks
- Maintenance compound
- Station or other building
- Work by others
- Drainage ditch
- Drainage pond
- Drainage attenuation tank (below ground)
- Drainage pumping station
- Noise barrier
- Proposed line of trees or hedgerow
- Enhanced line of trees or hedgerow
- Retained line of trees or hedgerow
- Flood compensation area
- Proposed grassland
- Proposed grassland and scattered trees
- Proposed woodland
- Proposed wetland
- Retained habitat (See note below)
- Enhanced habitat (See note below)

Where hatching appears over the environmental mitigation this indicates either retained mitigation (vertical lines) or enhanced mitigation (crosshatch)

Contains OS data © Crown Copyright and database right (2026)  
License no. AC0000830606



**PROPOSAL FOR CONSULTATION**

**EAST WEST RAIL**  
**Permanent Plan and Profile Drawings**

**Roxton to east of St Neots**  
**Route Section 5**  
**Sheet 02**

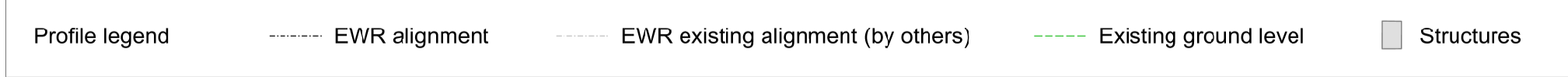
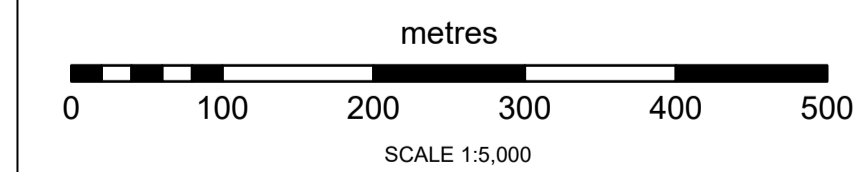
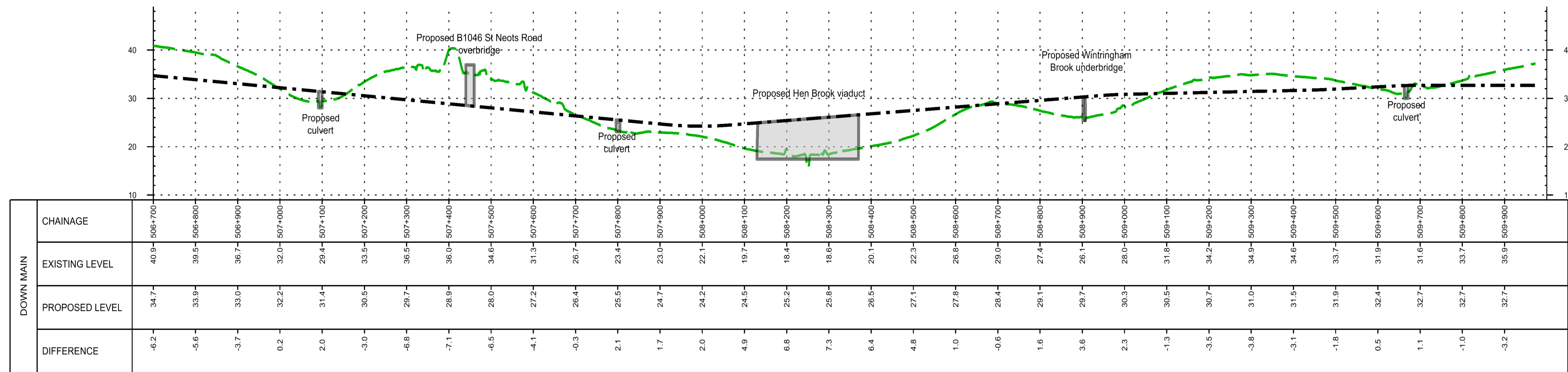
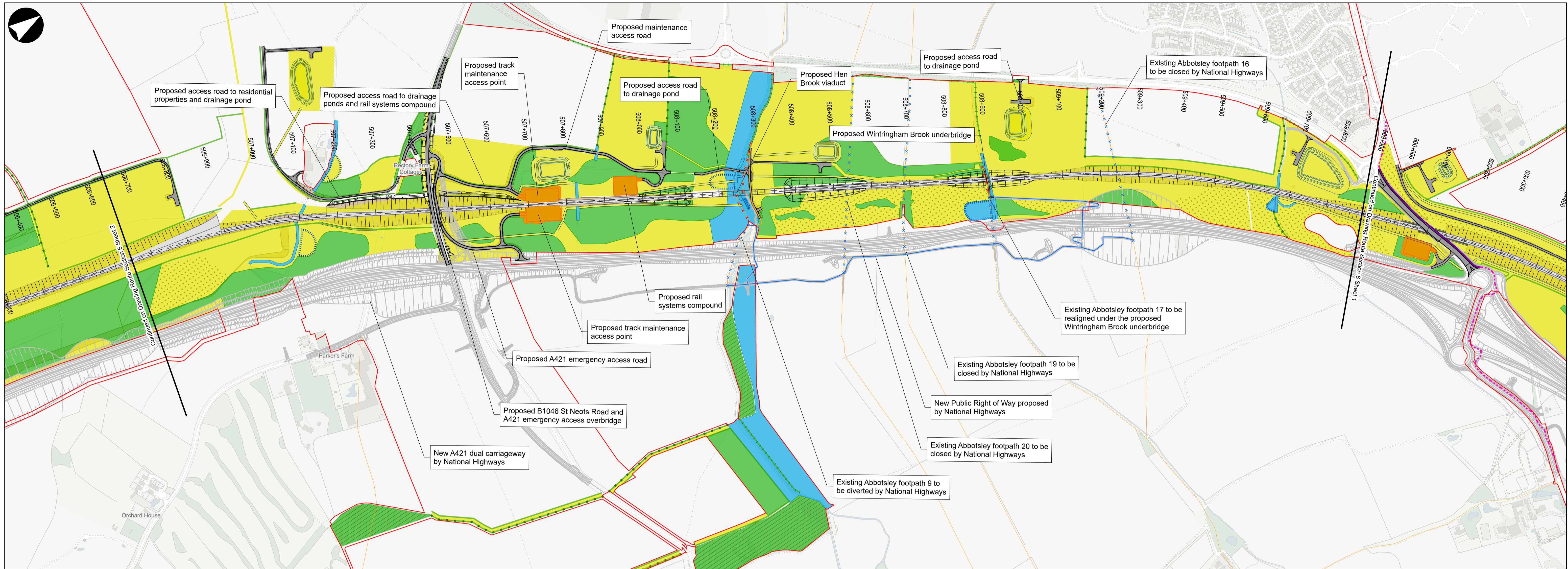

Contains OS data © Crown Copyright and database right (2026)  
License no. AC0000830606

- Draft Order Limits
- EWR alignment
- Chainage
- EWR existing alignment (by others)
- Bridges and retaining walls proposed
- Public Right of Way - existing
- Public Right of Way - proposed
- Public Right of Way - closed
- Public Right of Way - proposed by others

- Public Right of Way - closed by others
- EWR planned active travel route
- EWR planned active travel route (suitable for equestrians)
- Planned route by others
- River diversion
- Permanent highway (public and private)
- Engineering earthworks
- Maintenance compound
- Station or other building

- Work by others
- Drainage ditch
- Drainage pond
- Drainage attenuation tank (below ground)
- Drainage pumping station
- Noise barrier
- Proposed line of trees or hedgerow
- Enhanced line of trees or hedgerow
- Retained line of trees or hedgerow

- Flood compensation area
- Proposed grassland
- Proposed grassland and scattered trees
- Proposed woodland
- Proposed wetland
- Retained habitat (See note below)
- Enhanced habitat (See note below)

Where hatching appears over the environmental mitigation this indicates either retained mitigation (vertical lines) or enhanced mitigation (crosshatch)

**east west**  
RAIL



**PROPOSAL FOR CONSULTATION**

**EAST WEST RAIL**  
**Permanent Plan and Profile Drawings**

**Roxton to east of St Neots**  
**Route Section 5**  
**Sheet 03**

Project	Roxton to east of St Neots Route Section 5 Sheet 03	
Drawing Title	Roxton to east of St Neots Route Section 5 Sheet 03	
Drawing Number	133735-MWJ-Z0-XXX-DRG-CSE-001102	Drawing Rev
		P02