

Understanding our Drawings

We have prepared three sets of drawings to help you understand our proposals presented at this consultation and how you may be affected by them. These sets of drawings are:

- Temporary Plan Drawings – Drawing series 133735-MWJ-Z0-XXX-DRG-CSE-000100
- Permanent Plan Drawings – Drawing series 133735-MWJ-Z0-XXX-DRG-CSE-000101
- Permanent Plan and Profile Drawings – Drawing series 133735-MWJ-Z0-XXX-DRG-CSE-000102

For each route section from Oxford to Cambridge, these drawings show the boundary of our proposed works (the Draft Order Limits) and the type of works proposed in each area. The boundary of our proposed works includes our infrastructure proposals, indicative environmental mitigation such as tree planting and habitat improvement works as well as land that would be used temporarily for construction.

Our Permanent Plan and Profile drawings also show the proposed height (vertical alignment) of our proposals.

These drawings should be read in conjunction with our consultation document which describe our proposals.

What is shown on the Drawings

The Drawings show the boundary of our proposed works at this consultation. This includes land for new infrastructure, works to existing infrastructure and associated mitigation works including environmental mitigation as well as land that would be used temporarily for construction.

The Permanent Plan Drawings and Plan and Profile Drawings includes our proposals for:

- Track alignment including earthworks, bridges, viaducts and tunnels
- Highway works
- Drainage ponds to support the above
- Proposed station locations and indicative layouts
- Indicative large rail system assets including traction power compounds and telecom compounds (smaller rail system assets are not shown but are assumed to fit within the proposed railway corridor)
- Public Rights of Way (PRoW), including where existing PRoWs are being closed/diverted
- Active travel routes
- Access including railway maintenance access and access for landowners to their retained land
- Preliminary environmental mitigation proposals

The Temporary Plan Drawings show our proposals for:

- Main compounds
- Satellite compounds
- Stock pile locations,
- Service roads
- Major utility diversions
- Access and working areas needed to construct the permanent works

How our proposals will develop

The proposals at this consultation are based on preliminary designs to give you a general understanding of our proposals and to help inform feedback to the consultation. Your feedback, along with the results of further technical assessments, environmental impact assessment and mitigation proposals, will help us refine our proposals further before we submit our DCO application.

Other Points of Note

- All dimensions are in metres.
- Background OS mapping from 2021.
- Connection Stage 1 (CS1) between Gavray Junction and Bletchley has only recently completed construction so background mapping does not yet reflect as-built records
- The proposals shown are illustrative only for consultation purposes only and will be subject to change as part of design development and could require minor amendments to the Draft Order Limits.
- This map is provided as a visual reference. Due to its complexity, it may not be fully accessible to all users.

How you can use the Drawings

An example of a Plan and Profile drawing is shown below with an explanation to help you use the drawings. The same principles apply to all three sets of drawings. The numerical labels ① on the drawing correspond to the explanation below.

Our proposals are split into 8 route sections as indicated on the Drawing Map Index - 133735-MWJ-Z0-XXX-DRG-CSE-000097, 133735-MWJ-Z0-XXX-DRG-CSE-000098 and 133735-MWJ-Z0-XXX-DRG-CSE-000099. Each route section is given a different number, and within this each sheet is numbered ①.

The distance along the route section is shown using a bespoke chainage system ②. All chainages increase in a west to east direction with the first digit corresponding to the route section. For example Route Section 1 chainage starts at 100+000 and Route Section 2 chainage starts at 200+000. The distance between each chainage marker is 500 metres on the Plan drawings and 100 metres on the Plan and Profile drawings.

Each drawing shows a Plan of the area in question ③. For the Plan and Profiles we also show a profile for the same area as shown below ④. The Profile is the proposed vertical alignment of the railway relative to existing ground (to make level differences clearer to see the vertical scale is exaggerated by 10 times).

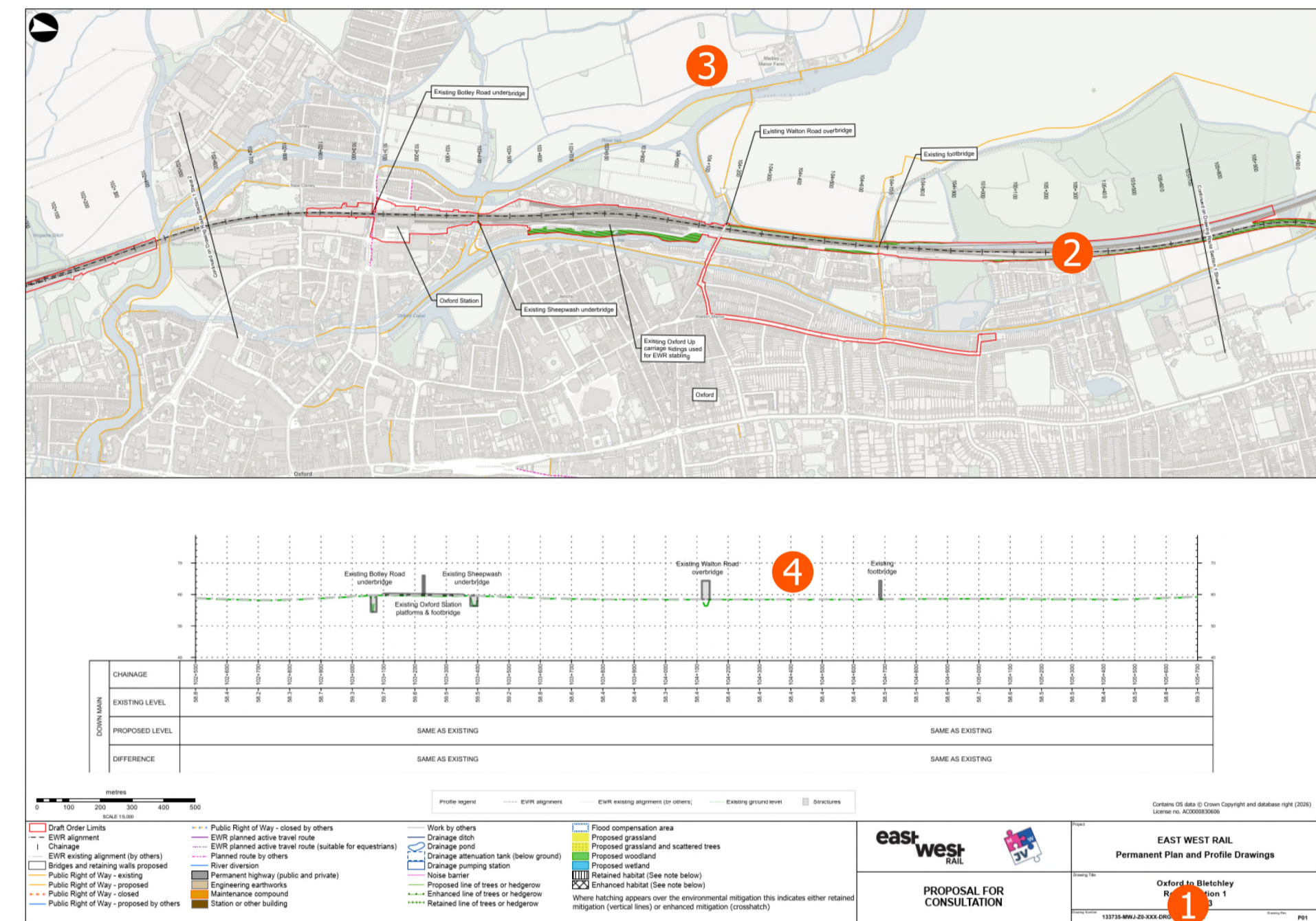

Status of the Drawings

Based on ongoing design work and feedback gathered this consultation, we will further refine our proposals and define the limits in which permanent works can be constructed. These are typically known as Limits of Deviation. Limits of Deviation help provide us with the necessary flexibility to avoid unforeseen issues. This includes engineering or environmental issues that were not known at the time of the DCO application. For temporary works, such as construction activities, mitigation works or planting works, these are not subject to Limits of Deviation, but can only take place within the Draft Order Limits.

Legend Extract

An extract is provided below which indicates which assets are shown on the Plan and Profiles and Permanent Plans.

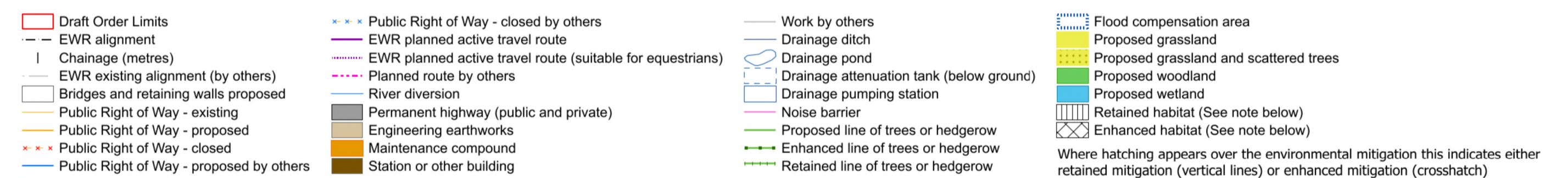

An extract is provided below which indicates which assets are shown on the Temporary Plans.

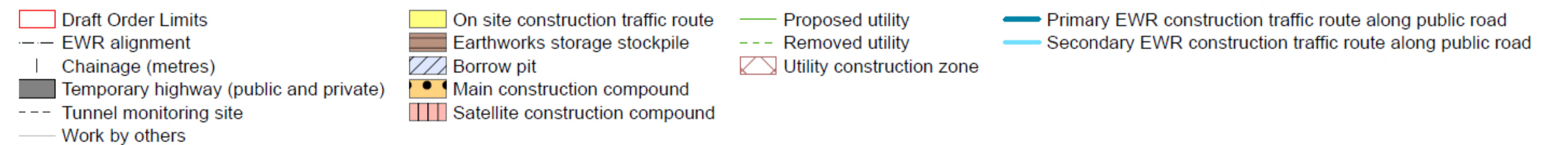

PROPOSAL FOR CONSULTATION

**EAST WEST RAIL
Plan and Profile**

**Oxford to Cambridge
Guide to the drawings**

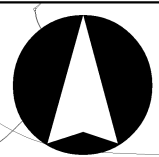

M1

ROUTE SECTION 5 Roxton to east of St Neots

ROUTE SECTION 6 Croxton to Toft

ROUTE SECTION 8 Cambridge

ROUTE SECTION 4 Clapham Green to Colesden

ROUTE SECTION 3 Bedford

ROUTE SECTION 1 Oxford to Bletchley

Milton Keynes

Bletchley

St Neots

Cambridge

M40

Bedford

Cambourne

M11 A11

ROUTE SECTION 7 Comberton to Shelford

ROUTE SECTION 2 Fenny Stratford to Kempston

M1

Luton

London Stansted airport

Bishops Stortford

Cherwell Valley Line

East Coast Main Line

West Coast Main Line

Midland Main Line

West Anglia Main Line

High Speed 2

Oxford

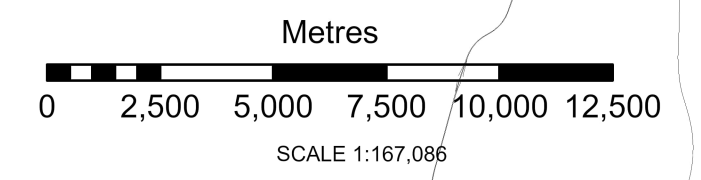

High Speed Two (HS2) Ltd.



EAST WEST RAIL

PROPOSAL FOR CONSULTATION

Temporary Drawings
Map Index

Drawing Number 133735-MWJ-Z0-XXX-DRG-CSE-000097

P01

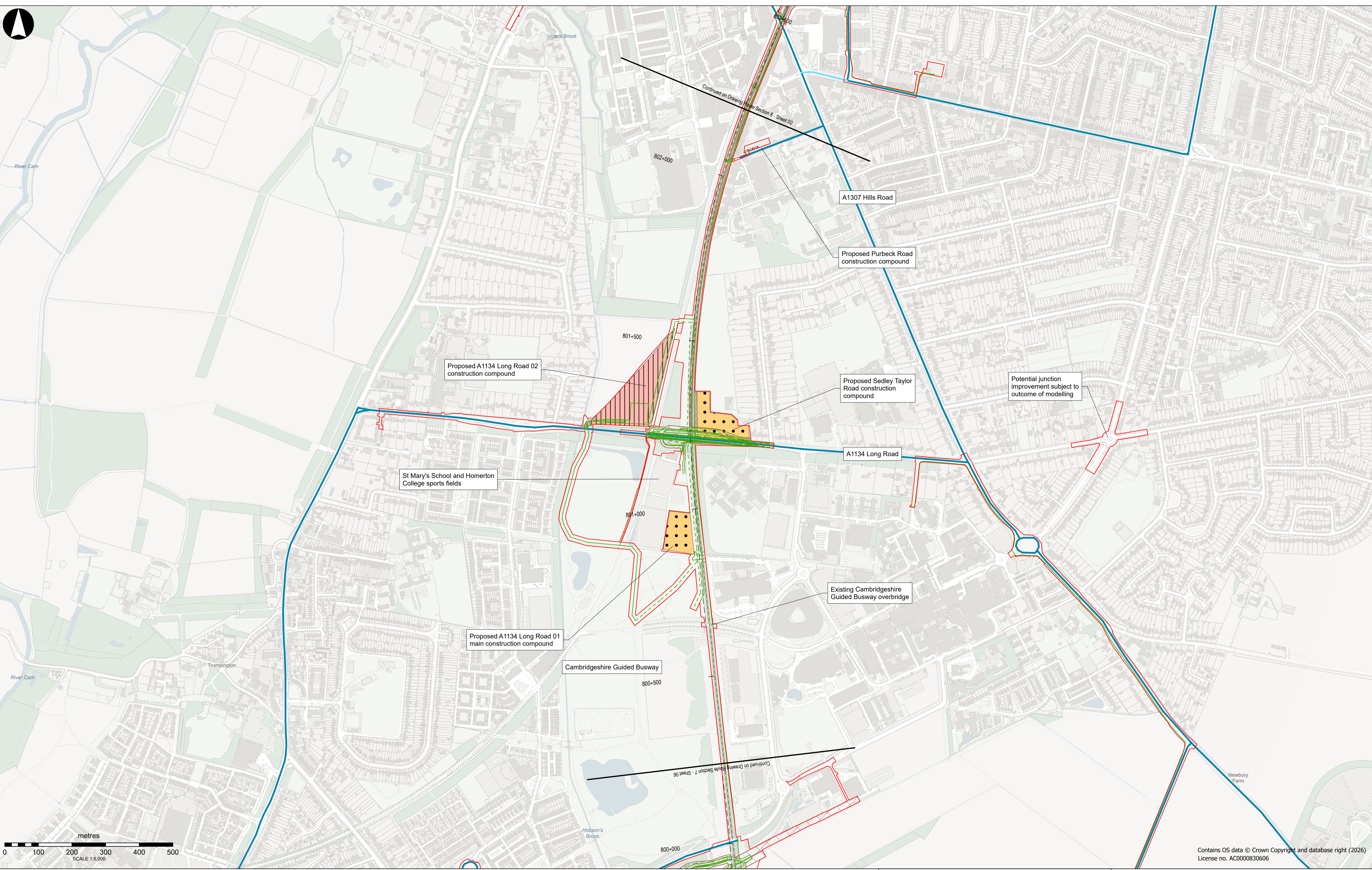

- Draft Order Limits
- EWR alignment
- Chainage (metres)
- Temporary highway (public and private)
- Tunnel monitoring site
- Work by others
- On site construction traffic route
- Earthworks storage stockpile
- Borrow pit
- Main construction compound
- Satellite construction compound
- Proposed utility
- Removed utility
- Utility construction zone
- Primary EWR construction traffic route along public road
- Secondary EWR construction traffic route along public road

Contains OS data © Crown Copyright and database right (2026)
License no. AC0000830606



**PROPOSAL FOR
CONSULTATION**

**EAST WEST RAIL
Temporary Drawings**

**Cambridge
Route Section 8
Sheet 01**

Project
Drawing Title
Drawing Number **133735-MWJ-Z0-XXX-DRG-CSE-000100**
Scale
Drawing Rev **P03**

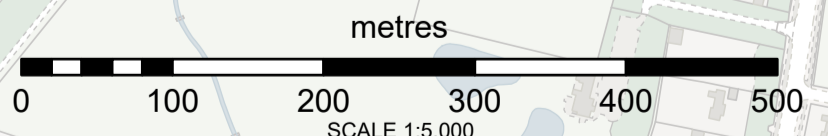
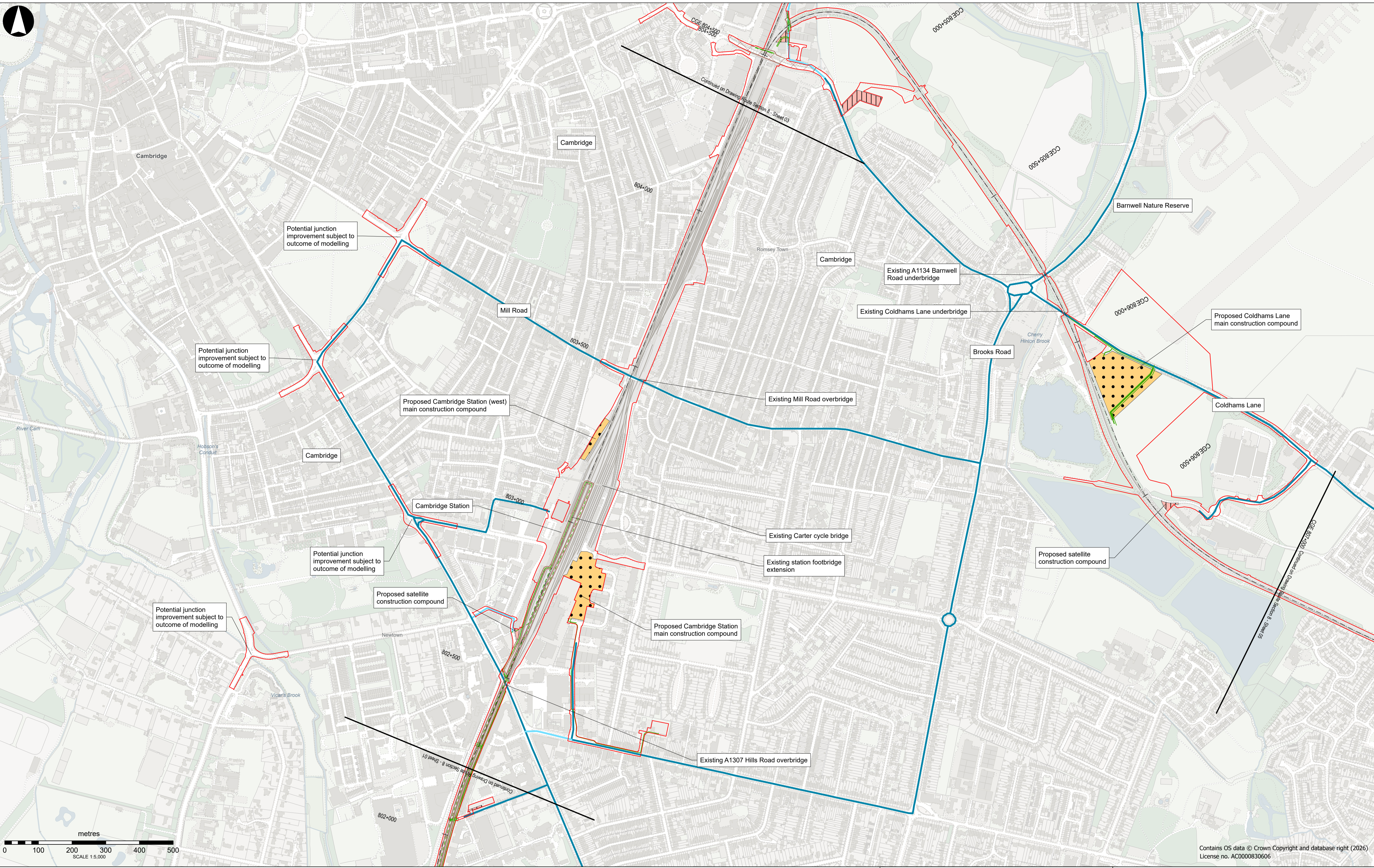

Contains OS data © Crown Copyright and database right (2026)
License no. AC0000830606

- | | | | |
|--|------------------------------------|---------------------------|--|
| Draft Order Limits | On site construction traffic route | Proposed utility | Primary EWR construction traffic route along public road |
| EWR alignment | Earthworks storage stockpile | Removed utility | Secondary EWR construction traffic route along public road |
| Chainage (metres) | Borrow pit | Utility construction zone | |
| Temporary highway (public and private) | Main construction compound | | |
| Tunnel monitoring site | Satellite construction compound | | |
| Work by others | | | |



PROPOSAL FOR CONSULTATION

**EAST WEST RAIL
Temporary Drawings**

**Cambridge
Route Section 8
Sheet 02**

Project		
Drawing Title		
Drawing Number	133735-MWJ-Z0-XXX-DRG-CSE-000100	Drawing Rev
		P03

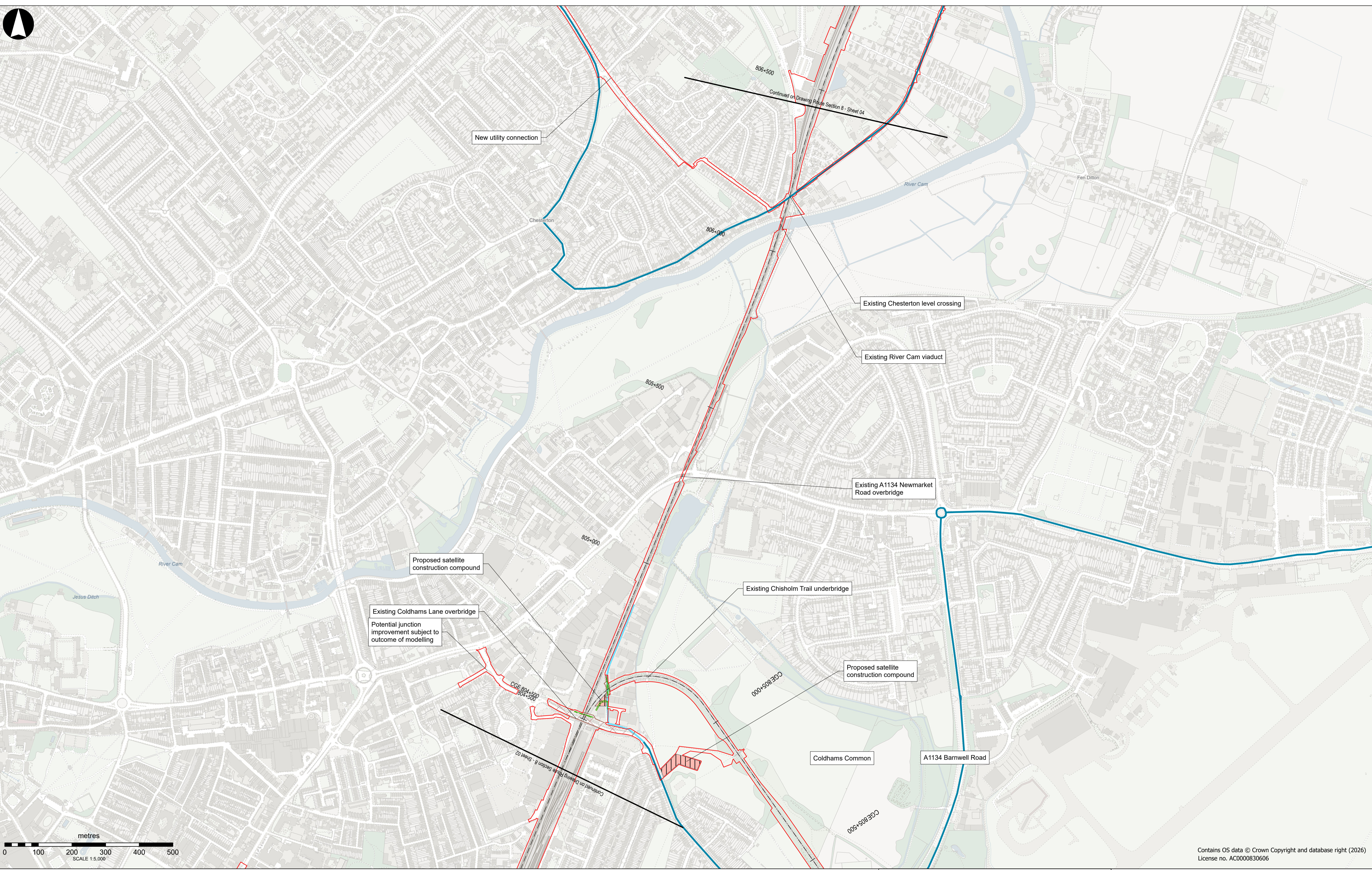

- Draft Order Limits
- EWR alignment
- Chainage (metres)
- Temporary highway (public and private)
- Tunnel monitoring site
- Work by others
- On site construction traffic route
- Earthworks storage stockpile
- Borrow pit
- Main construction compound
- Satellite construction compound
- Proposed utility
- Removed utility
- Utility construction zone
- Primary EWR construction traffic route along public road
- Secondary EWR construction traffic route along public road

Contains OS data © Crown Copyright and database right (2026)
License no. AC0000830606



PROPOSAL FOR CONSULTATION

**EAST WEST RAIL
Temporary Drawings**

**Cambridge
Route Section 8
Sheet 03**

Project
Drawing Title
Drawing Number **133735-MWJ-Z0-XXX-DRG-CSE-000100**
Drawing Rev **P03**

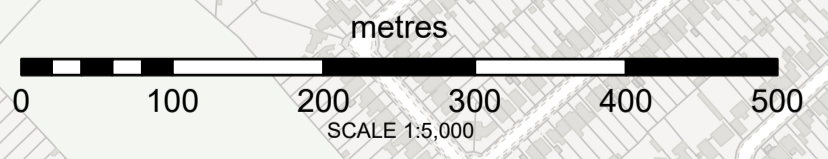
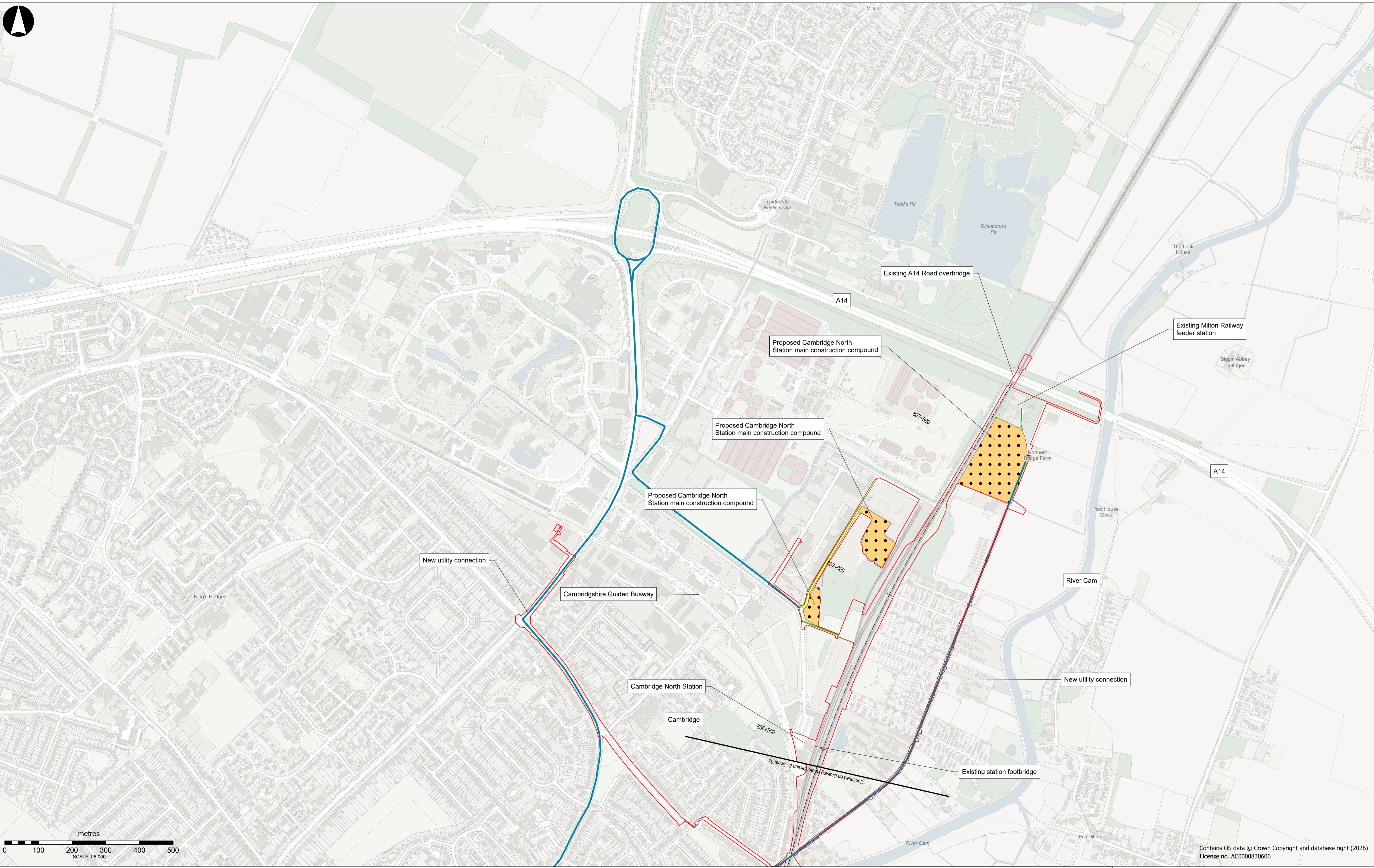

- Draft Order Limits
- EWR alignment
- Chainage (metres)
- Temporary highway (public and private)
- Tunnel monitoring site
- Work by others
- On site construction traffic route
- Earthworks storage stockpile
- Borrow pit
- Main construction compound
- Satellite construction compound
- Proposed utility
- Removed utility
- Utility construction zone
- Primary EWR construction traffic route along public road
- Secondary EWR construction traffic route along public road



PROPOSAL FOR CONSULTATION

**EAST WEST RAIL
Temporary Drawings**

**Cambridge
Route Section 8
Sheet 04**

Project

Drawing Title

Drawing Number **133735-MWJ-Z0-XXX-DRG-CSE-000100**

License no. AC0000830606

Contains OS data © Crown Copyright and database right (2026)

Drawing Rev **P03**

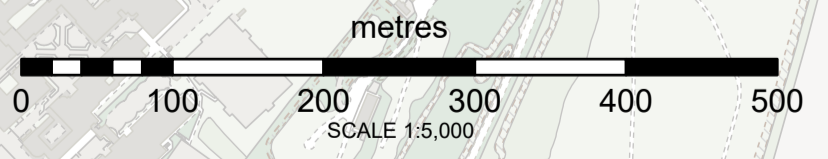
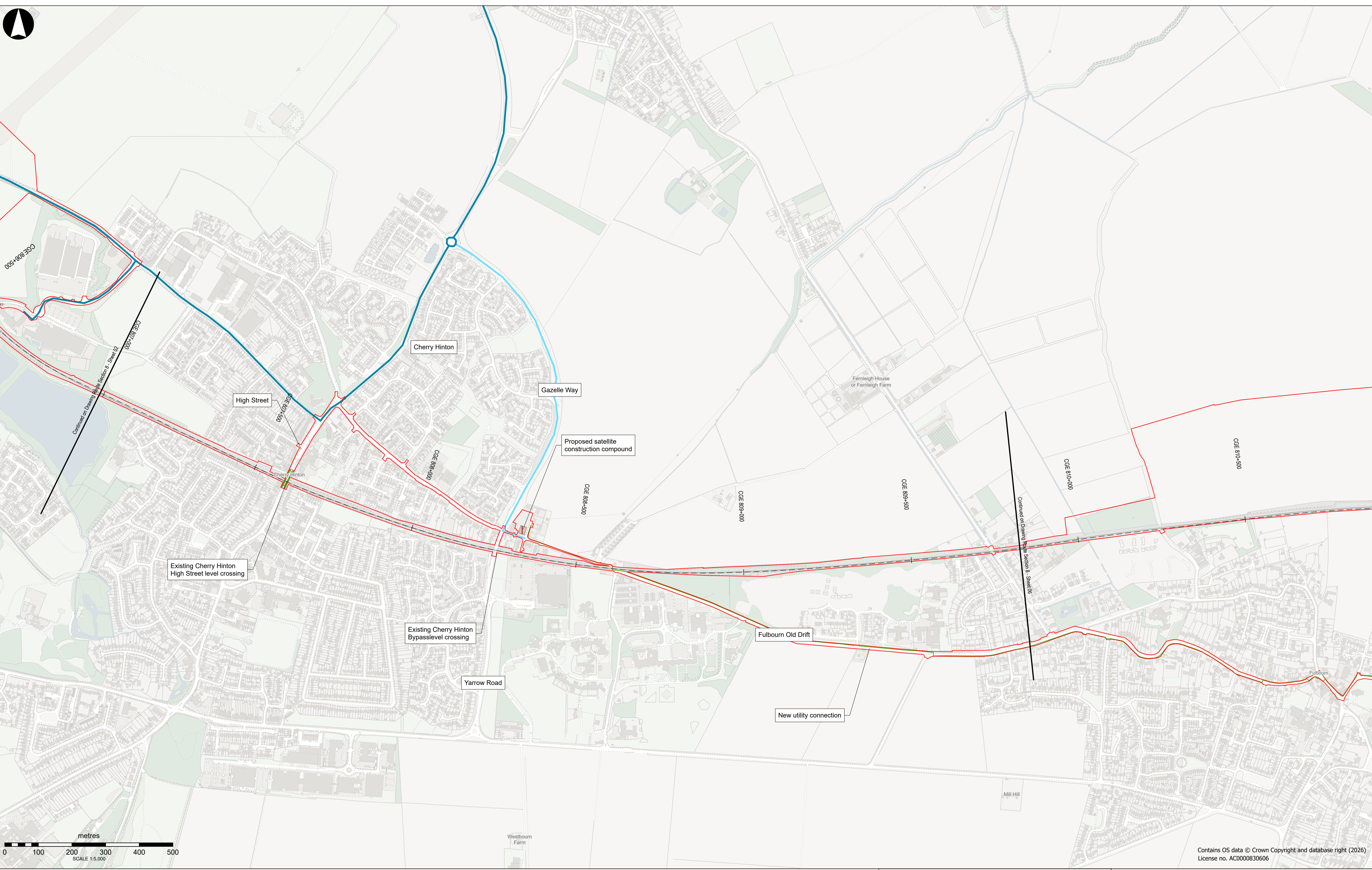

Contains OS data © Crown Copyright and database right (2026)
License no. AC0000830606

- Draft Order Limits
- EWR alignment
- Chainage (metres)
- Temporary highway (public and private)
- Tunnel monitoring site
- Work by others
- On site construction traffic route
- Earthworks storage stockpile
- Borrow pit
- Main construction compound
- Satellite construction compound
- Proposed utility
- Removed utility
- Utility construction zone
- Primary EWR construction traffic route along public road
- Secondary EWR construction traffic route along public road



PROPOSAL FOR CONSULTATION

**EAST WEST RAIL
Temporary Drawings**

**Cambridge
Route Section 8
Sheet 05**

Project

Drawing Title

Drawing Number **133735-MWJ-Z0-XXX-DRG-CSE-000100** Drawing Rev **P03**

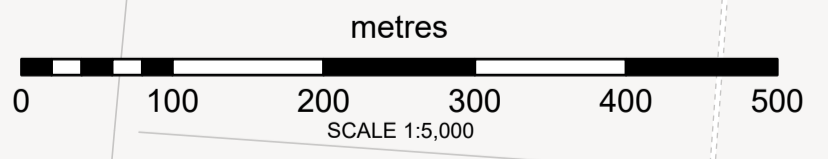
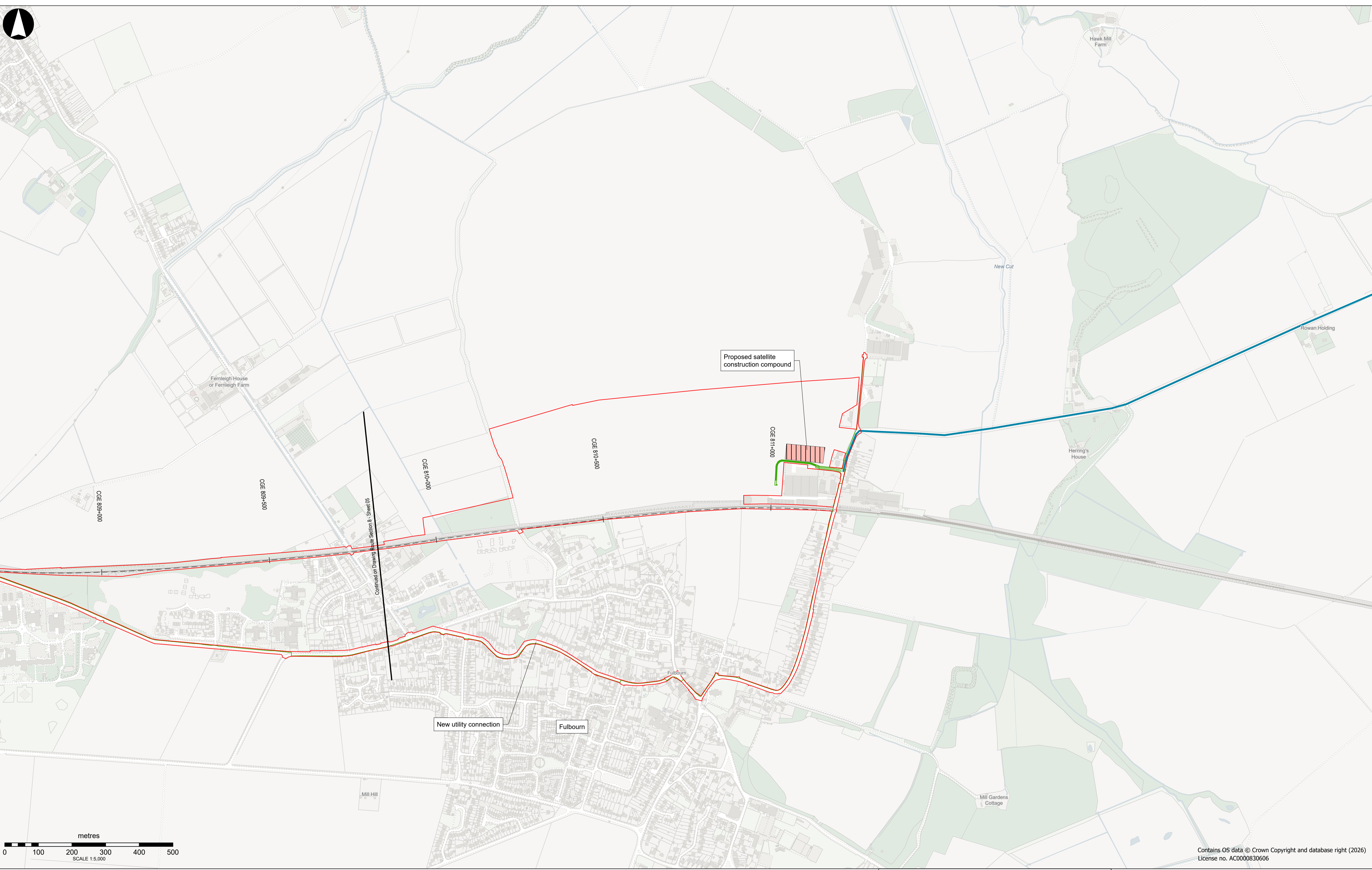

Contains OS data © Crown Copyright and database right (2026)
License no. AC0000830606

- | | | | |
|--|------------------------------------|---------------------------|--|
| Draft Order Limits | On site construction traffic route | Proposed utility | Primary EWR construction traffic route along public road |
| EWR alignment | Earthworks storage stockpile | Removed utility | Secondary EWR construction traffic route along public road |
| Chainage (metres) | Borrow pit | Utility construction zone | |
| Temporary highway (public and private) | Main construction compound | | |
| Tunnel monitoring site | Satellite construction compound | | |
| Work by others | | | |



PROPOSAL FOR CONSULTATION

**EAST WEST RAIL
Temporary Drawings**

**Cambridge
Route Section 8
Sheet 06**

Project	
Drawing Title	
Drawing Number	133735-MWJ-Z0-XXX-DRG-CSE-000100
Drawing Rev	P03

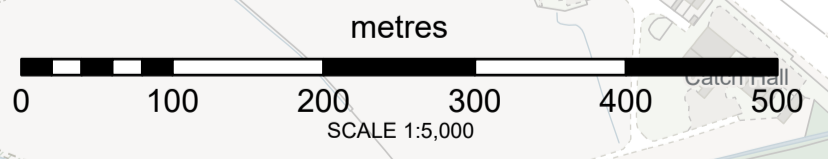
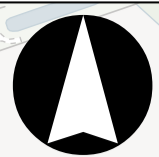

Contains OS data © Crown Copyright and database right (2026)
License no. AC0000830606

- | | | | |
|--|------------------------------------|---------------------------|--|
| Draft Order Limits | On site construction traffic route | Proposed utility | Primary EWR construction traffic route along public road |
| EWR alignment | Earthworks storage stockpile | Removed utility | Secondary EWR construction traffic route along public road |
| Chainage (metres) | Borrow pit | Utility construction zone | |
| Temporary highway (public and private) | Main construction compound | | |
| Tunnel monitoring site | Satellite construction compound | | |
| Work by others | | | |



PROPOSAL FOR CONSULTATION

**EAST WEST RAIL
Temporary Drawings**

**Cambridge
Route Section 8
Sheet 07**

Project	
Drawing Title	
Drawing Number	133735-MWJ-Z0-XXX-DRG-CSE-000100
Drawing Rev	P03