

PLAN
SCALE 1:5000 @ A1

- Profile Legend:
- - - - EWR vertical alignment
 - - - - Existing vertical alignment
 - - - - Existing ground

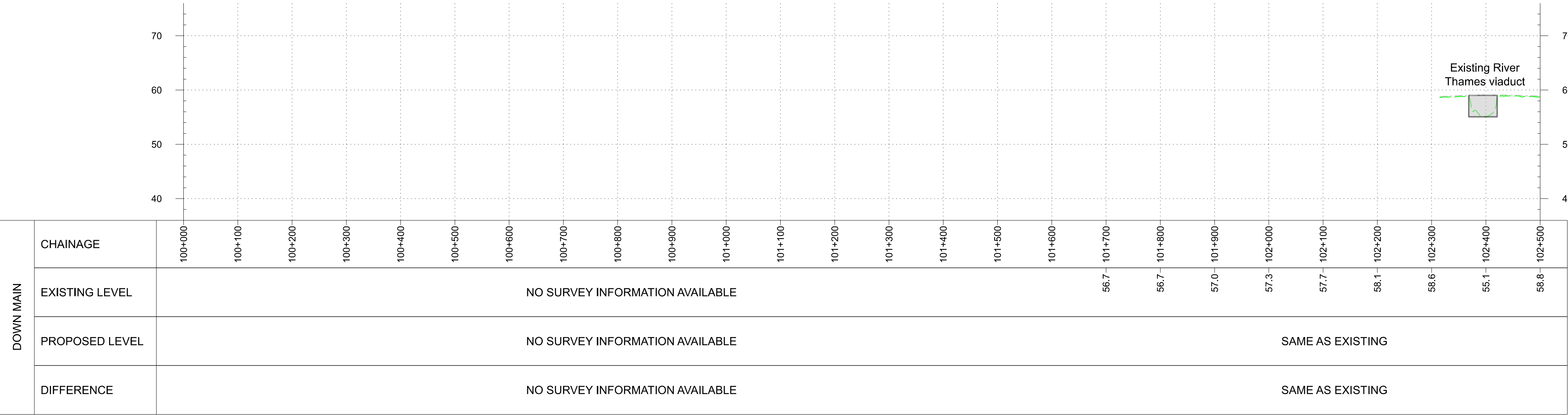

PROFILE
SCALE H:1:5000 V:1:500 @ A1

OS map data reproduced by permission of Ordnance Survey on behalf of HMSO. © Crown copyright 2021. All rights reserved. Ordnance Survey licence number AC0000830608
This document is issued for the party which commissioned it and for specific purposes connected with the captioned project only. It should not be relied upon by any other party or used for any other purpose.
We accept no responsibility for the consequences of this document being relied upon by any other party, or being used for any other purpose, or containing any error or omission which is due to an error or omission in data supplied to us by other parties.

These drawings are indicative and for consultation purposes only
For guidance and general notes refer to drawing 133735-MWJ-Z0-XXX-DRG-CSE-000002

Legend/Notes

Draft Order Limits	Engineering earthworks (embankment)	Construction & logistic sites	Habitat creation - woodland	Public Right of Way - existing
EWR alignment	Engineering earthworks (cutting)	Telecoms compound	Habitat creation - hedgerow	Public Right of Way - closed
Chainage (metres)	Landscape mitigation earthworks (embankment)	Traction power compound	Habitat creation - grassland	Public Right of Way - proposed
Permanent highway (public and private)	Landscape mitigation earthworks (cutting)	Bridges and retaining walls	Habitat creation - wetland	Balancing pond (indicative)
EWR existing alignment (by others)		Noise mitigation (indicative)	Public realm / station car parking	Drainage attenuation tank (below ground)
Construction zone (by others)		Station or other building	Preliminary utilities diversion	
		Utilities construction zone		

Project
East West Rail
Oxford to Cambridge

Drawing Title
DCO Non-Statutory Consultation
Oxford to Bletchley
Route Section 1
Sheet 1

east west RAIL

One Grafton Mews, Midsummer Boulevard, Milton Keynes, Buckinghamshire, MK9 1FB

Designed MWJV	Signed	Date	Checked M.KYNOCH	Signed MK	Date 04/11/24
Drawn J.SYMONDS	Signed JS	Date 04/11/24	Approved M.PENFOLD	Signed MP	Date 04/11/24
Scale(s) 1:5000	Status Information		Suitability Code S2	Sheet 1 of 76	Revision P02

Drawing Number
133735-MWJ-Z0-XXX-DRG-CSE-100001

Molt MacDonald House, 8-10 Sydenham Road, Croydon, CR20 2EE.
WSP House, Chancery Lane, London, WC2A 1AF.

MW JV

P01	10/06/24	Prepared for Information	JS	MP	
P02	04/11/24	Prepared for Non-Statutory Consultation	JS	MB	MP
Rev	Date	Description of Revisions	Drawn	Chkd	Appr

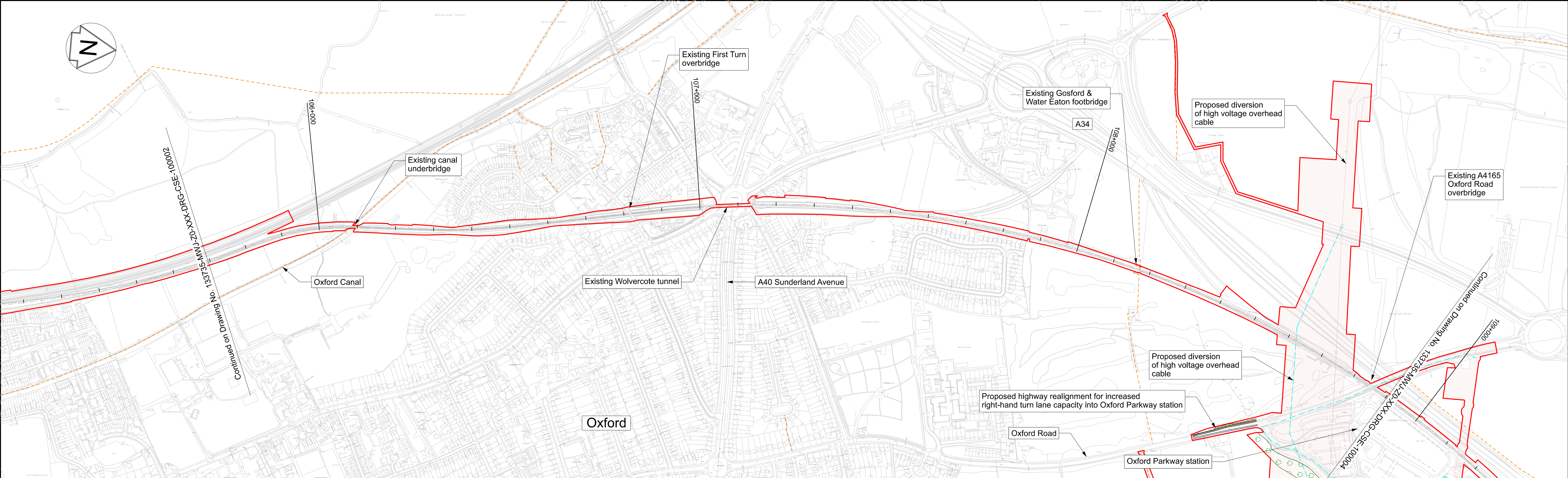

PLAN
SCALE 1:5000 @ A1

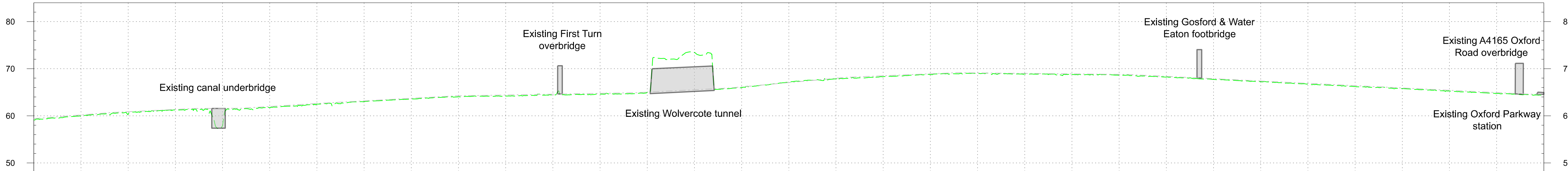

DOWN MAIN	CHAINAGE	105+700	105+800	105+900	106+000	106+100	106+200	106+300	106+400	106+500	106+600	106+700	106+800	106+900	107+000	107+100	107+200	107+300	107+400	107+500	107+600	107+700	107+800	107+900	108+000	108+100	108+200	108+300	108+400	108+500	108+600	108+700	108+800	108+900
	EXISTING LEVEL	59.1	59.9	60.3	61.2	57.8	61.7	62.5	63.0	63.6	64.0	64.2	64.5	64.6	64.9	73.4	66.0	67.2	67.8	68.3	68.7	69.0	68.9	68.8	68.6	68.2	67.7	67.2	66.7	66.2	65.8	65.3	64.7	64.4
	PROPOSED LEVEL	SAME AS EXISTING																																
	DIFFERENCE	SAME AS EXISTING																																

PROFILE
SCALE H:1:5000 V:1:500 @ A1

OS map data reproduced by permission of Ordnance Survey on behalf of HMSO. © Crown copyright 2021. All rights reserved. Ordnance Survey licence number AC0000830606
This document is issued for the party which commissioned it and for specific purposes connected with the captioned project only. It should not be relied upon by any other party or used for any other purpose.
We accept no responsibility for the consequences of this document being relied upon by any other party, or being used for any other purpose, or containing any error or omission which is due to an error or omission in data supplied to us by other parties.

Legend/Notes

- Draft Order Limits
- EWR alignment
- Chainage (metres)
- Permanent highway (public and private)
- EWR existing alignment (by others)
- Construction zone (by others)

- Engineering earthworks (embankment)
- Engineering earthworks (cutting)
- Landscape mitigation earthworks (embankment)
- Landscape mitigation earthworks (cutting)

- Construction & logistic sites
- Telecoms compound
- Traction power compound
- Bridges and retaining walls
- Noise mitigation (indicative)
- Station or other building
- Utilities construction zone

- Habitat creation - woodland
- Habitat creation - hedgerow
- Habitat creation - scrub
- Habitat creation - grassland
- Habitat creation - wetland
- Public realm / station car parking

- Public Right of Way - existing
- Public Right of Way - closed
- Public Right of Way - proposed
- Balancing pond (indicative)
- Drainage attenuation tank (below ground)
- Preliminary utilities diversion

Project

East West Rail
Oxford to Cambridge

Drawing Title

DCO Non-Statutory Consultation
Oxford to Bletchley
Route Section 1
Sheet 3

Designed: MWJV
Drawn: J.SYMONDS
Scale(s): 1:5000
Drawing Number: 133735-MWJ-Z0-XXX-DRG-CSE-100003

Signed: JS
Status: Information

Checked: M.KYNOCH
Approved: M.PENFOLD

Signed: MK
Signed: MP
Suitability Code: S2

Date: 04/11/24
Date: 04/11/24
Revision: 3 of 76
Revision: P02

east west RAIL

One Grafton Mews, Midsummer Boulevard, Milton Keynes, Buckinghamshire, MK9 1FB

Molt MacDonald House, 8-10 Sydenham Road, Croydon, CR20 2EE, WSP House, Chancery Lane, London, WC2A 1AF.

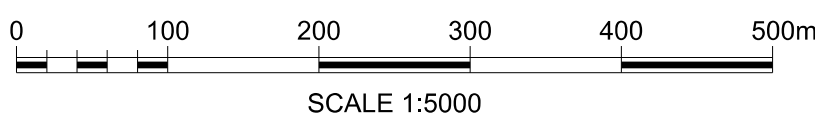
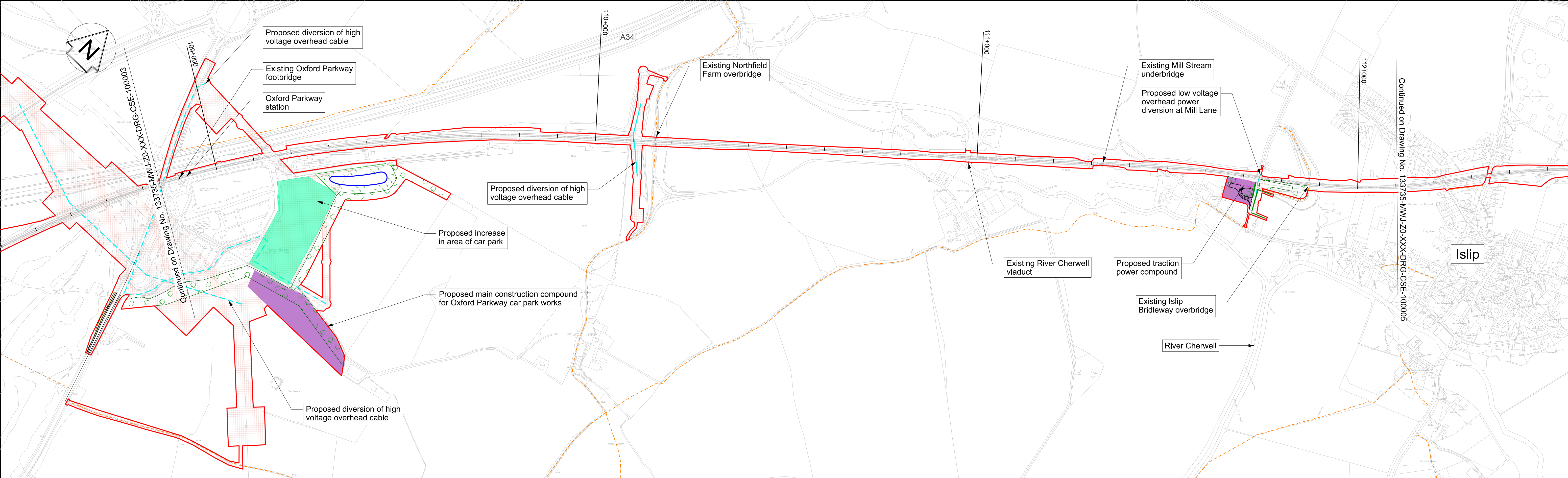

PLAN
SCALE 1:5000 @ A1

- Profile Legend:
- EWR vertical alignment
 - - - Existing vertical alignment
 - - - Existing ground

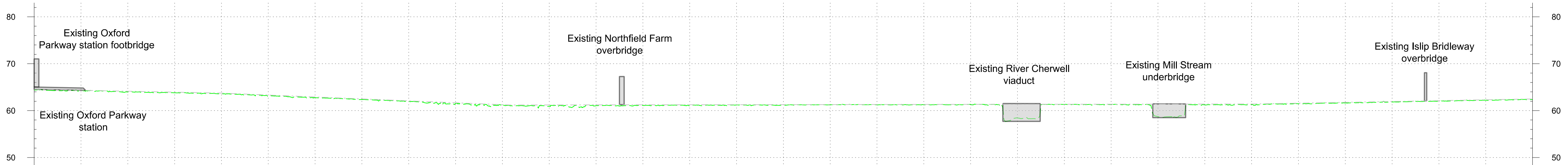

DOWN MAIN	CHAINAGE	108+900	109+000	109+100	109+200	109+300	109+400	109+500	109+600	109+700	109+800	109+900	110+000	110+100	110+200	110+300	110+400	110+500	110+600	110+700	110+800	110+900	111+000	111+100	111+200	111+300	111+400	111+500	111+600	111+700	111+800	111+900	112+000	112+100
	EXISTING LEVEL	64.4	64.2	64.0	63.8	63.6	63.1	62.8	62.4	62.0	61.5	61.0	60.9	61.1	61.1	61.0	61.2	61.2	61.2	61.2	61.3	61.3	58.4	61.3	61.3	58.7	61.2	61.3	61.5	61.6	61.8	62.0	62.2	62.3
	PROPOSED LEVEL	SAME AS EXISTING																																
	DIFFERENCE	SAME AS EXISTING																																

PROFILE
SCALE H:1:5000 V:1:500 @ A1

OS map data reproduced by permission of Ordnance Survey on behalf of HMSO. © Crown copyright 2021. All rights reserved. Ordnance Survey licence number AC0000830608

This document is issued for the party which commissioned it and for specific purposes connected with the captioned project only. It should not be relied upon by any other party or used for any other purpose. We accept no responsibility for the consequences of this document being relied upon by any other party, or being used for any other purpose, or containing any error or omission which is due to an error or omission in data supplied to us by other parties.

These drawings are indicative and for consultation purposes only
For guidance and general notes refer to drawing 133735-MWJ-Z0-XXX-DRG-CSE-000002

Legend/Notes

- Draft Order Limits
- EWR alignment
- Chainage (metres)
- Permanent highway (public and private)
- EWR existing alignment (by others)
- Construction zone (by others)
- Engineering earthworks (embankment)
- Engineering earthworks (cutting)
- Landscape mitigation earthworks (embankment)
- Landscape mitigation earthworks (cutting)
- Construction & logistic sites
- Telecoms compound
- Traction power compound
- Bridges and retaining walls
- Noise mitigation (indicative)
- Station or other building
- Utilities construction zone
- Habitat creation - woodland
- Habitat creation - hedgerow
- Habitat creation - scrub
- Habitat creation - grassland
- Habitat creation - wetland
- Public realm / station car parking
- Public Right of Way - existing
- Public Right of Way - closed
- Public Right of Way - proposed
- Balancing pond (indicative)
- Drainage attenuation tank (below ground)
- Preliminary utilities diversion

Project
East West Rail
Oxford to Cambridge

Drawing Title
DCO Non-Statutory Consultation
Oxford to Bletchley
Route Section 1
Sheet 4

east west RAIL

One Grafton Mews, Midsummer Boulevard, Milton Keynes, Buckinghamshire, MK9 1FB

Designed MWJV	Signed JS	Date 04/11/24	Checked M.KYNOCH	Signed MK	Date 04/11/24
Drawn J.SYMONDS	Signed JS	Date 04/11/24	Approved M.PENFOLD	Signed MP	Date 04/11/24
Scale(s) 1:5000	Status Information	Suitability Code S2		Sheet 4 of 76	
Drawing Number 133735-MWJ-Z0-XXX-DRG-CSE-100004				Revision P02	

Molt MacDonald House, 8-10 Sydenham Road, Croydon, CR20 2EE.
WSP House, Chancery Lane, London, WC2A 1AF.

Rev	Date	Description of Revisions	Drawn	Chkd	Appr
P01	10/06/24	Prepared for Information	JS	MP	
P02	04/11/24	Prepared for Non-Statutory Consultation	JS	MB	MP

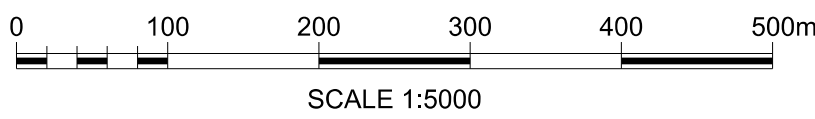
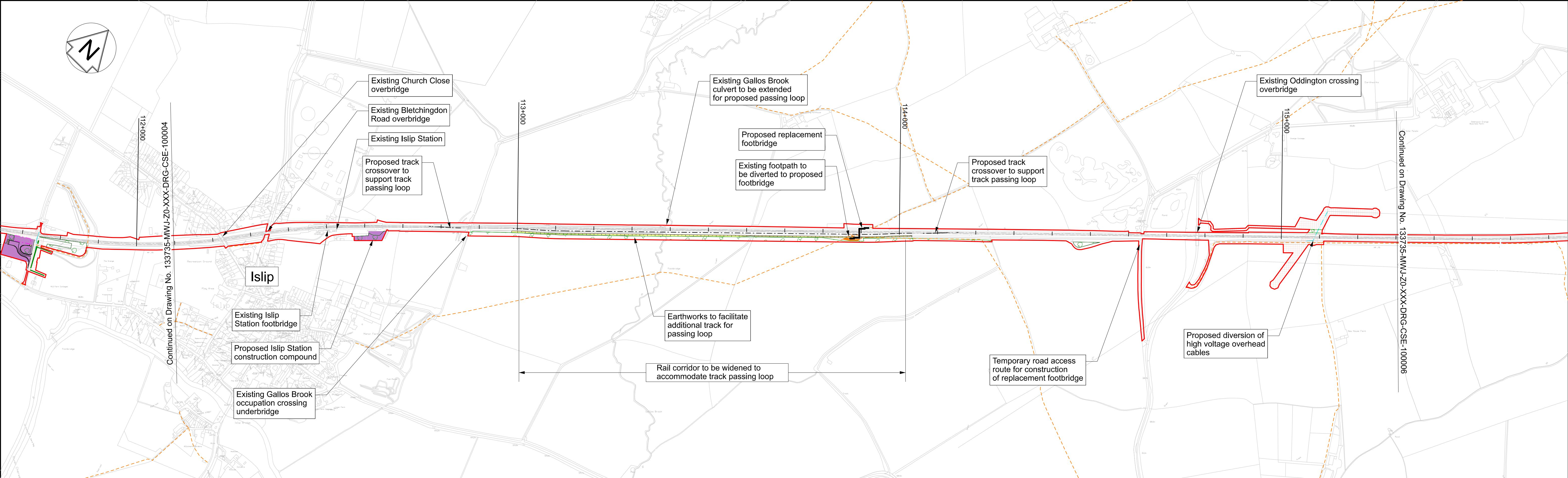

PLAN
SCALE 1:5000 @ A1

Profile Legend:
- - - EWR vertical alignment
- - - Existing vertical alignment
- - - Existing ground

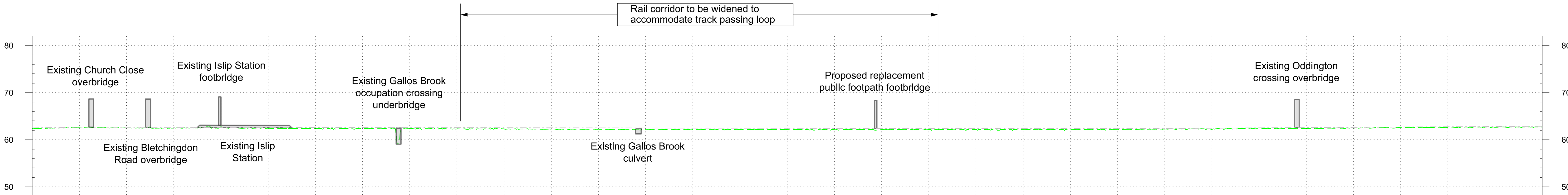

DOWN MAIN	CHAINAGE	112+100	112+200	112+300	112+400	112+500	112+600	112+700	112+800	112+900	113+000	113+100	113+200	113+300	113+400	113+500	113+600	113+700	113+800	113+900	114+000	114+100	114+200	114+300	114+400	114+500	114+600	114+700	114+800	114+900	115+000	115+100	115+200	115+300
	EXISTING LEVEL	62.3	62.5	62.5	62.5	62.8	62.5	62.4	62.4	62.3	62.3	62.3	62.3	62.2	62.2	62.2	62.2	62.2	62.1	62.2	62.2	62.2	62.2	62.2	62.2	62.3	62.2	62.4	62.4	62.5	62.6	62.6	62.6	62.7
	PROPOSED LEVEL	SAME AS EXISTING																										SAME AS EXISTING						
	DIFFERENCE	SAME AS EXISTING																										SAME AS EXISTING						

PROFILE
SCALE H:1:5000 V:1:500 @ A1

OS map data reproduced by permission of Ordnance Survey on behalf of HMSO. © Crown copyright 2021. All rights reserved. Ordnance Survey licence number AC0000830606
This document is issued for the party which commissioned it and for specific purposes connected with the captioned project only. It should not be relied upon by any other party or used for any other purpose.
We accept no responsibility for the consequences of this document being relied upon by any other party, or being used for any other purpose, or containing any error or omission which is due to an error or omission in data supplied to us by other parties.

Legend/Notes

Draft Order Limits

EWR alignment

Chainage (metres)

Permanent highway (public and private)

EWR existing alignment (by others)

Construction zone (by others)

Engineering earthworks (embankment)

Engineering earthworks (cutting)

Landscape mitigation earthworks (embankment)

Landscape mitigation earthworks (cutting)

Construction & logistic sites

Telecoms compound

Traction power compound

Bridges and retaining walls

Noise mitigation (indicative)

Station or other building

Utilities construction zone

Habitat creation - woodland

Habitat creation - hedgerow

Habitat creation - scrub

Habitat creation - grassland

Habitat creation - wetland

Public realm / station car parking

Public Right of Way - existing

Public Right of Way - closed

Public Right of Way - proposed

Balancing pond (indicative)

Drainage attenuation tank (below ground)

Preliminary utilities diversion

Project

East West Rail
Oxford to Cambridge

Drawing Title

DCO Non-Statutory Consultation
Oxford to Bletchley
Route Section 1
Sheet 5

Designed

MWJV

Signed

JS

Date

04/11/24

Checked

M.KYNOCH

Signed

MP

Date

04/11/24

Scale(s)

1:5000

Status

Information

Suitability Code

S2

Revision

P02

One Grafton Mews, Midsummer Boulevard, Milton Keynes, Buckinghamshire, MK9 1FB

Molt MacDonald House, 8-10 Sydenham Road, Croydon, CR20 2EE, WSP House, Chancery Lane, London, WC2A 1AF.

5 of 76

133735-MWJ-Z0-XXX-DRG-CSE-100005

P02

Sheet Size A1 841 x 594

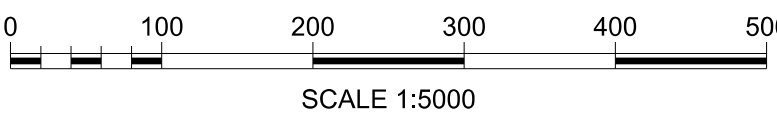
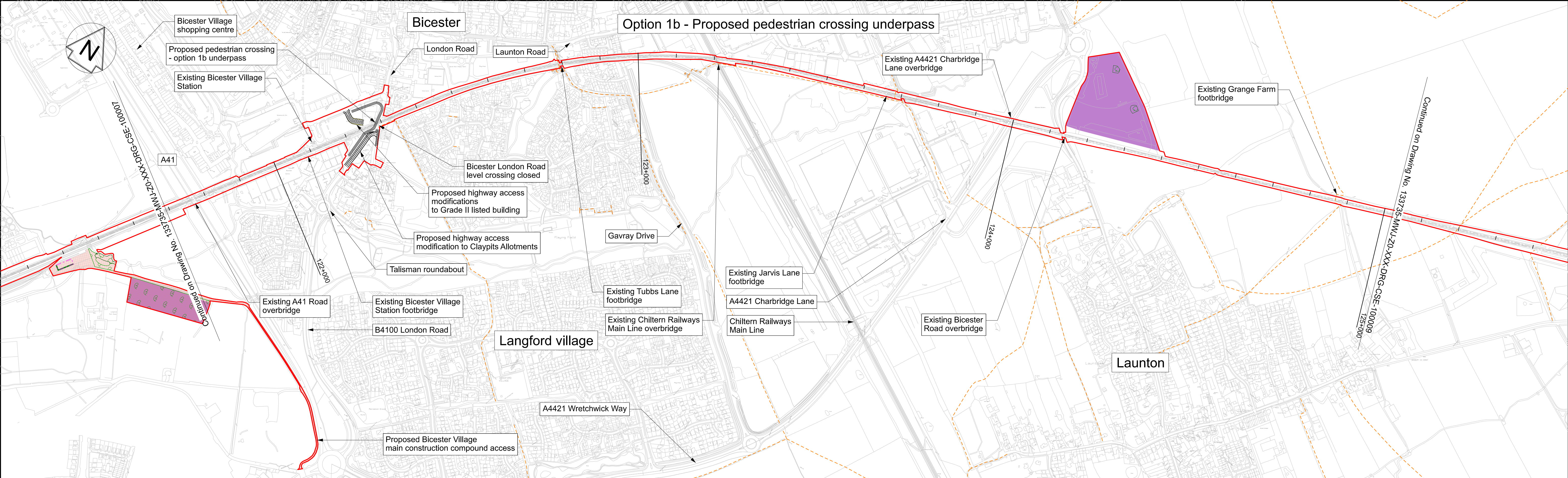

PLAN
SCALE 1:5000 @ A1

- Profile Legend:
- EWR vertical alignment
 - - - Existing vertical alignment
 - Existing ground

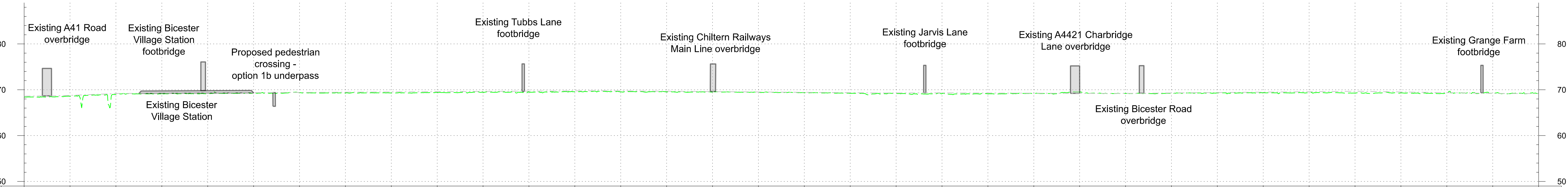

DOWN MAIN	CHAINAGE	121+700	121+800	121+900	122+000	122+100	122+200	122+300	122+400	122+500	122+600	122+700	122+800	122+900	123+000	123+100	123+200	123+300	123+400	123+500	123+600	123+700	123+800	123+900	124+000	124+100	124+200	124+300	124+400	124+500	124+600	124+700	124+800	124+900	125+000
	EXISTING LEVEL	68.4	68.6	69.0	69.2	69.2	69.2	69.4	69.3	69.3	69.4	69.5	69.5	69.6	69.6	69.5	69.5	69.4	69.3	69.2	69.2	69.2	69.1	69.2	69.5	69.2	69.3	69.3	69.4	69.4	69.3	69.3	69.2	69.3	69.2
	PROPOSED LEVEL	SAME AS EXISTING																SAME AS EXISTING																	
	DIFFERENCE	SAME AS EXISTING																SAME AS EXISTING																	

PROFILE
SCALE H:1:5000 V:1:500 @ A1

OS map data reproduced by permission of Ordnance Survey on behalf of HMSO. © Crown copyright 2021. All rights reserved. Ordnance Survey licence number AC0000830608

This document is issued for the party which commissioned it and for specific purposes connected with the captioned project only. It should not be relied upon by any other party or used for any other purpose.

We accept no responsibility for the consequences of this document being relied upon by any other party, or being used for any other purpose, or containing any error or omission which is due to an error or omission in data supplied to us by other parties.

Legend/Notes

- Draft Order Limits
- EWR alignment
- Chainage (metres)
- Permanent highway (public and private)
- EWR existing alignment (by others)
- Construction zone (by others)

- Engineering earthworks (embankment)
- Engineering earthworks (cutting)
- Landscape mitigation earthworks (embankment)
- Landscape mitigation earthworks (cutting)

- Construction & logistic sites
- Telecoms compound
- Traction power compound
- Bridges and retaining walls
- Noise mitigation (indicative)
- Station or other building
- Utilities construction zone

- Habitat creation - woodland
- Habitat creation - hedgerow
- Habitat creation - scrub
- Habitat creation - grassland
- Habitat creation - wetland
- Public realm / station car parking

- Public Right of Way - existing
- Public Right of Way - closed
- Public Right of Way - proposed
- Balancing pond (indicative)
- Drainage attenuation tank (below ground)
- Preliminary utilities diversion

Project
**East West Rail
Oxford to Cambridge**

Drawing Title
**DCO Non-Statutory Consultation
Oxford to Bletchley
Route Section 1
Sheet 8 Option 1b**

**east west
RAIL**

One Grafton Mews, Midsummer Boulevard, Milton Keynes, Buckinghamshire, MK9 1FB

Molt MacDonald House, 8-10 Sydenham Road, Croydon, CR20 2EE, WSP House, Chancery Lane, London, WC2A 1AF.

Designed **MWJV** Signed Date

Drawn **J.SYMONDS** Signed **JS** Date **04/11/24**

Scale(s) **1:5000** Status **Information**

Drawing Number **133735-MWJ-Z0-XXX-DRG-CSE-100108**

M JV

Checked **M.KYNOCH** Signed **MK** Date **04/11/24**

Approved **M.PENFOLD** Signed **MP** Date **04/11/24**

Suitability Code **S2** Sheet **18 of 76**

Revision **P02**

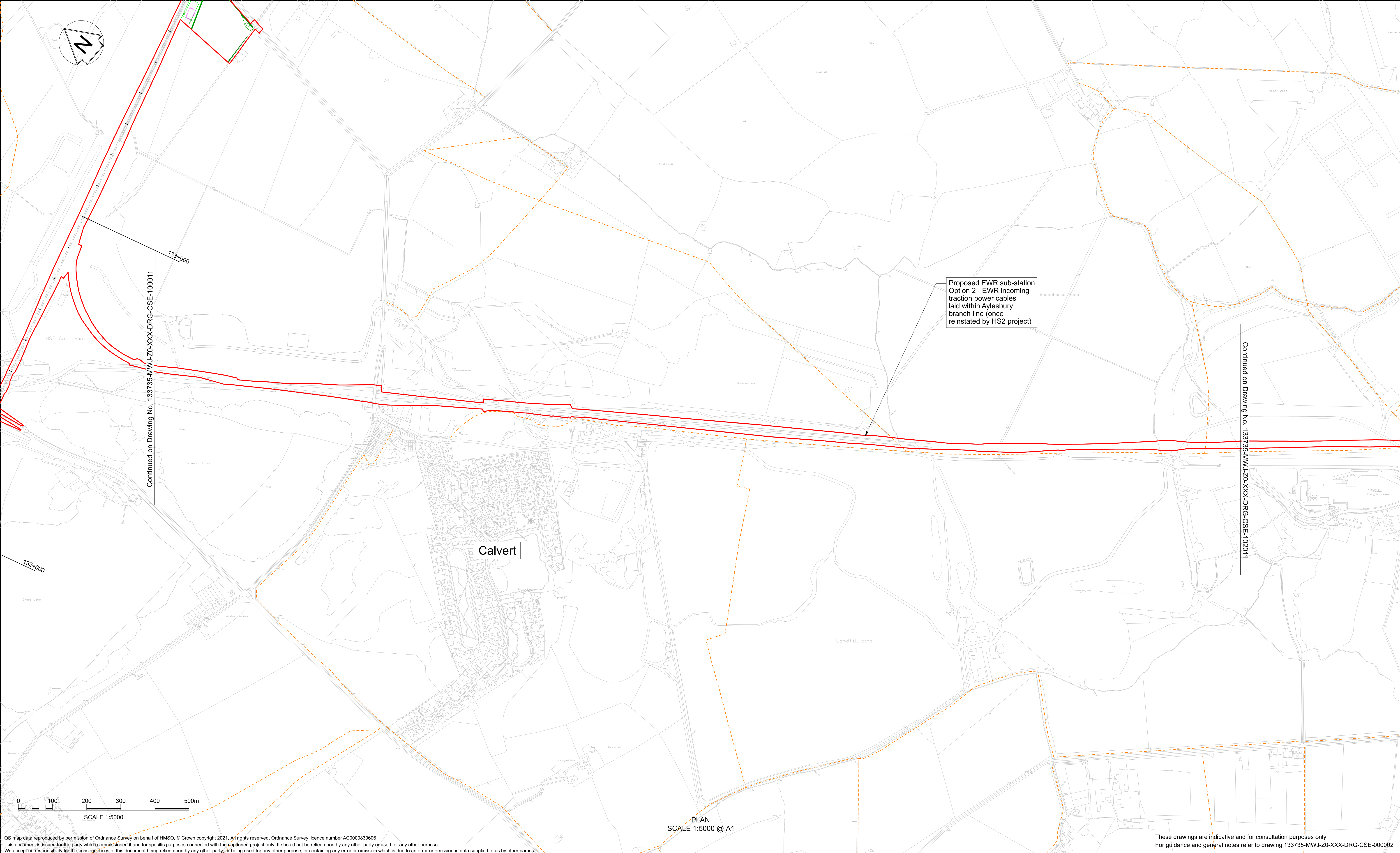

OS map data reproduced by permission of Ordnance Survey on behalf of HMSO. © Crown copyright 2021. All rights reserved. Ordnance Survey licence number AC0000830608
This document is issued for the party which commissioned it and for specific purposes connected with the captioned project only. It should not be relied upon by any other party or used for any other purpose.
We accept no responsibility for the consequences of this document being relied upon by any other party, or being used for any other purpose, or containing any error or omission which is due to an error or omission in data supplied to us by other parties.

Rev	Date	Description of Revisions	Drawn	Chkd	Appr
P01	10/06/24	Prepared for Information	JS	MP	
P02	04/11/24	Prepared for Non-Statutory Consultation	JS	MB	MP

	Draft Order Limits
	EWR alignment
	Chainage (metres)
	Permanent highway (public and private)
	EWR existing alignment (by others)
	Construction zone (by others)

	Engineering earthworks (embankment)
	Engineering earthworks (cutting)
	Landscape mitigation earthworks (embankment)
	Landscape mitigation earthworks (cutting)

	Construction & logistic sites
	Telecoms compound
	Traction power compound
	Bridges and retaining walls
	Noise mitigation (indicative)
	Station or other building
	Utilities construction zone

	Habitat creation - woodland
	Habitat creation - hedgerow
	Habitat creation - scrub
	Habitat creation - grassland
	Habitat creation - wetland
	Public realm / station car parking

	Public Right of Way - existing
	Public Right of Way - closed
	Public Right of Way - proposed
	Balancing pond (indicative)
	Drainage attenuation tank (below ground)
	Preliminary utilities diversion

Project

East West Rail
Oxford to Cambridge

Drawing Title

DCO Non-Statutory Consultation
Oxford to Bletchley
Route Section 1
Sheet 11a

One Grafton Mews, Midsummer Boulevard, Milton Keynes, Buckinghamshire, MK9 1FB

Mott MacDonald House, 8-10 Sydenham Road, Croydon, CR20 2EE.
WSP House, Chancery Lane, London, WC2A 1AF.

Designed MWJV	Signed JS	Date 04/11/24	Checked M.KYNOCH	Signed MK	Date 04/11/24
Drawn J.SYMONDS	Signed JS	Date 04/11/24	Approved M.PENFOLD	Signed MP	Date 04/11/24
Scale(s) 1:5000	Status Information		Suitability Code S2	19 of 76	Sheet
Drawing Number				Revision P02	

133735-MWJ-Z0-XXX-DRG-CSE-101011

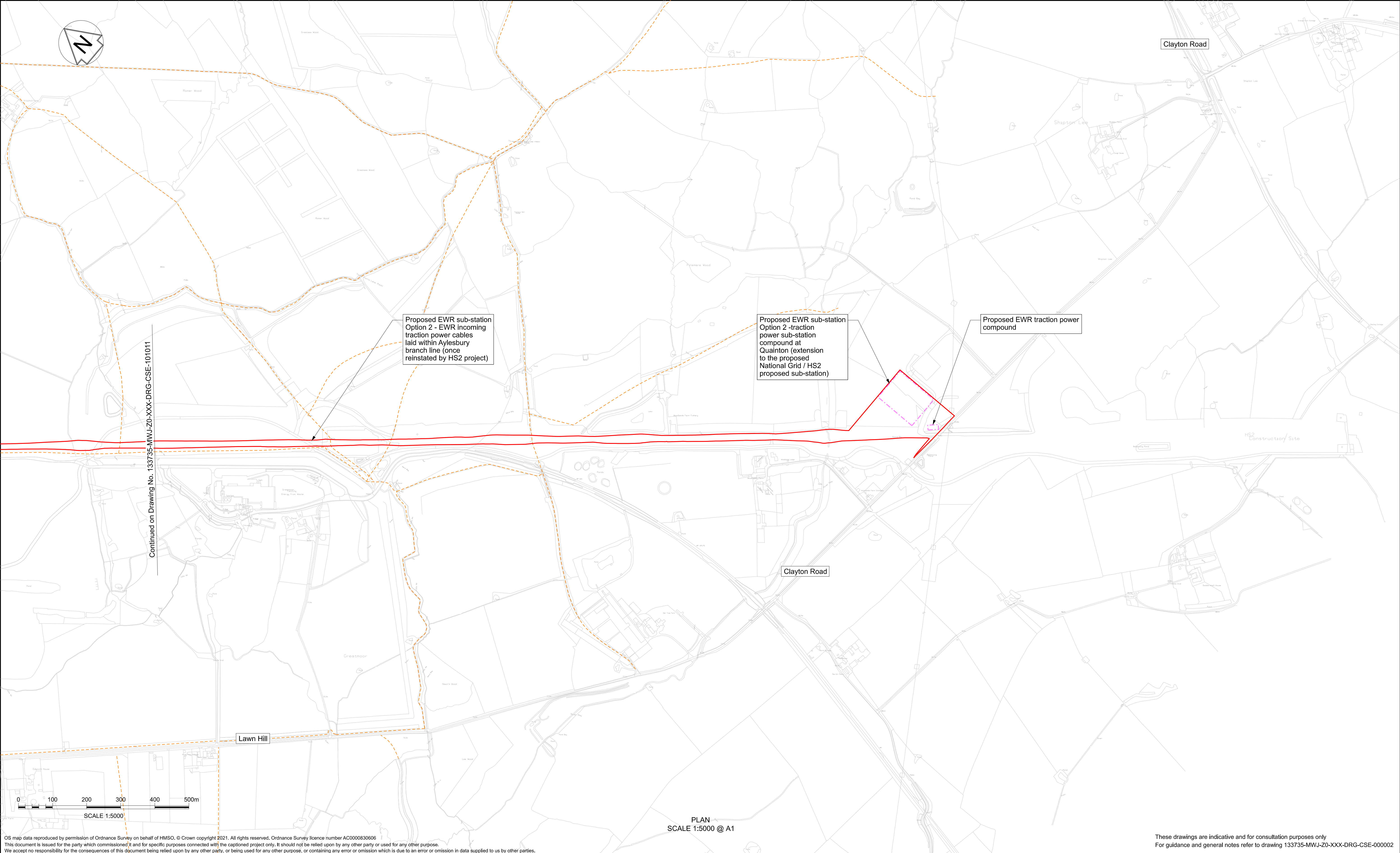

OS map data reproduced by permission of Ordnance Survey on behalf of HMSO. © Crown copyright 2021. All rights reserved. Ordnance Survey licence number AC0000830608
This document is issued for the party which commissioned it and for specific purposes connected with the captioned project only. It should not be relied upon by any other party or used for any other purpose.
We accept no responsibility for the consequences of this document being relied upon by any other party, or being used for any other purpose, or containing any error or omission which is due to an error or omission in data supplied to us by other parties.

Legend/Notes					Project				
<div><div><div><div><div></div><div></div></div><div>Draft Order Limits</div></div><div><div><div><div></div><div></div></div><div>EWR alignment</div></div><div><div><div><div></div><div></div></div><div>Chainage (metres)</div></div><div><div><div><div></div><div></div></div><div>Permanent highway (public and private)</div></div><div><div><div><div></div><div></div></div><div>EWR existing alignment (by others)</div></div><div><div><div><div></div><div></div></div><div>Construction zone (by others)</div></div></div></div><div><div><div><div></div><div></div></div><div>Engineering earthworks (embankment)</div></div><div><div><div><div></div><div></div></div><div>Engineering earthworks (cutting)</div></div><div><div><div><div></div><div></div></div><div>Landscape mitigation earthworks (embankment)</div></div><div><div><div><div></div><div></div></div><div>Landscape mitigation earthworks (cutting)</div></div></div></div><div><div><div><div></div><div></div></div><div>Construction & logistic sites</div></div><div><div><div><div></div><div></div></div><div>Telecoms compound</div></div><div><div><div><div></div><div></div></div><div>Traction power compound</div></div><div><div><div><div></div><div></div></div><div>Bridges and retaining walls</div></div><div><div><div><div></div><div></div></div><div>Noise mitigation (indicative)</div></div><div><div><div><div></div><div></div></div><div>Station or other building</div></div><div><div><div><div></div><div></div></div><div>Utilities construction zone</div></div></div></div><div><div><div><div></div><div></div></div><div>Habitat creation - woodland</div></div><div><div><div><div></div><div></div></div><div>Habitat creation - hedgerow</div></div><div><div><div><div></div><div></div></div><div>Habitat creation - scrub</div></div><div><div><div><div></div><div></div></div><div>Habitat creation - grassland</div></div><div><div><div><div></div><div></div></div><div>Habitat creation - wetland</div></div><div><div><div><div></div><div></div></div><div>Public realm / station car parking</div></div></div></div><div><div><div><div></div><div></div></div><div>Public Right of Way - existing</div></div><div><div><div><div></div><div></div></div><div>Public Right of Way - closed</div></div><div><div><div><div></div><div></div></div><div>Public Right of Way - proposed</div></div><div><div><div><div></div><div></div></div><div>Balancing pond (indicative)</div></div><div><div><div><div></div><div></div></div><div>Drainage attenuation tank (below ground)</div></div><div><div><div><div></div><div></div></div><div>Preliminary utilities diversion</div></div></div></div></div></div></div></div></div></div></div></div></div></div></div></div></div></div></div></div></div></div></div></div>	<div><div><div><div><div></div><div></div></div><div>East West Rail</div><div>Oxford to Cambridge</div></div><div><div><div><div><div></div><div></div></div><div>DCO Non-Statutory Consultation</div><div>Oxford to Bletchley</div><div>Route Section 1</div><div>Sheet 11b</div></div></div></div><div><div><div><div><div></div><div></div></div><div>Designed</div><div>MWJV</div></div><div><div><div><div></div><div></div></div><div>Signed</div><div>J.SYMONDS</div></div><div><div><div><div></div><div></div></div><div>Date</div><div>04/11/24</div></div><div><div><div><div></div><div></div></div><div>Scale(s)</div><div>1:5000</div></div></div></div><div><div><div><div><div></div><div></div></div><div>Checked</div><div>M.KYNOCH</div></div><div><div><div><div></div><div></div></div><div>Signed</div><div>MP</div></div><div><div><div><div></div><div></div></div><div>Date</div><div>04/11/24</div></div><div><div><div><div></div><div></div></div><div>Status</div><div>Information</div></div><div><div><div><div></div><div></div></div><div>Approved</div><div>M.PENFOLD</div></div><div><div><div><div></div><div></div></div><div>Signed</div><div>MP</div></div><div><div><div><div></div><div></div></div><div>Date</div><div>04/11/24</div></div><div><div><div><div></div><div></div></div><div>Suitability Code</div><div>S2</div></div><div><div><div><div></div><div></div></div><div>Revision</div><div>P02</div></div></div></div></div><div><div><div><div><div></div><div></div></div><div>Designed</div><div>MWJV</div></div><div><div><div><div></div><div></div></div><div>Signed</div><div>J.SYMONDS</div></div><div><div><div><div></div><div></div></div><div>Date</div><div>04/11/24</div></div><div><div><div><div></div><div></div></div><div>Scale(s)</div><div>1:5000</div></div></div></div><div><div><div><div><div></div><div></div></div><div>Checked</div><div>M.KYNOCH</div></div><div><div><div><div></div><div></div></div><div>Signed</div><div>MP</div></div><div><div><div><div></div><div></div></div><div>Date</div><div>04/11/24</div></div><div><div><div><div></div><div></div></div><div>Status</div><div>Information</div></div><div><div><div><div></div><div></div></div><div>Approved</div><div>M.PENFOLD</div></div><div><div><div><div></div><div></div></div><div>Signed</div><div>MP</div></div><div><div><div><div></div><div></div></div><div>Date</div><div>04/11/24</div></div><div><div><div><div></div><div></div></div><div>Suitability Code</div><div>S2</div></div><div><div><div><div></div><div></div></div><div>Revision</div><div>P02</div></div></div></div></div><div><div><div><div><div></div><div></div></div><div>Designed</div><div>MWJV</div></div><div><div><div><div></div><div></div></div><div>Signed</div><div>J.SYMONDS</div></div><div><div><div><div></div><div></div></div><div>Date</div><div>04/11/24</div></div><div><div><div><div></div><div></div></div><div>Scale(s)</div><div>1:5000</div></div></div></div><div><div><div><div><div></div><div></div></div><div>Checked</div><div>M.KYNOCH</div></div><div><div><div><div></div><div></div></div><div>Signed</div><div>MP</div></div><div><div><div><div></div><div></div></div><div>Date</div><div>04/11/24</div></div><div><div><div><div></div><div></div></div><div>Status</div><div>Information</div></div><div><div><div><div></div><div></div></div><div>Approved</div><div>M.PENFOLD</div></div><div><div><div><div></div><div></div></div><div>Signed</div><div>MP</div></div><div><div><div><div></div><div></div></div><div>Date</div><div>04/11/24</div></div><div><div><div><div></div><div></div></div><div>Suitability Code</div><div>S2</div></div><div><div><div><div></div><div></div></div><div>Revision</div><div>P02</div></div></div></div></div><div><div><div><div><div></div><div></div></div><div>Designed</div><div>MWJV</div></div><div><div><div><div></div><div></div></div><div>Signed</div><div>J.SYMONDS</div></div><div><div><div><div></div><div></div></div><div>Date</div><div>04/11/24</div></div><div><div><div><div></div><div></div></div><div>Scale(s)</div><div>1:5000</div></div></div></div><div><div><div><div><div></div><div></div></div><div>Checked</div><div>M.KYNOCH</div></div><div><div><div><div></div><div></div></div><div>Signed</div><div>MP</div></div><div><div><div><div></div><div></div></div><div>Date</div><div>04/11/24</div></div><div><div><div><div></div><div></div></div><div>Status</div><div>Information</div></div><div><div><div><div></div><div></div></div><div>Approved</div><div>M.PENFOLD</div></div><div><div><div><div></div><div></div></div><div>Signed</div><div>MP</div></div><div><div><div><div></div><div></div></div><div>Date</div><div>04/11/24</div></div><div><div><div><div></div><div></div></div><div>Suitability Code</div><div>S2</div></div><div><div><div><div></div><div></div></div><div>Revision</div><div>P02</div></div></div></div></div><div><div><div><div><div></div><div></div></div><div>Designed</div><div>MWJV</div></div><div><div><div><div></div><div></div></div><div>Signed</div><div>J.SYMONDS</div></div><div><div><div><div></div><div></div></div><div>Date</div><div>04/11/24</div></div><div><div><div><div></div><div></div></div><div>Scale(s)</div><div>1:5000</div></div></div></div><div><div><div><div><div></div><div></div></div><div>Checked</div><div>M.KYNOCH</div></div><div><div><div><div></div><div></div></div><div>Signed</div><div>MP</div></div><div><div><div><div></div><div></div></div><div>Date</div><div>04/11/24</div></div><div><div><div><div></div><div></div></div><div>Status</div><div>Information</div></div><div><div><div><div></div><div></div></div><div>Approved</div><div>M.PENFOLD</div></div><div><div><div><div></div><div></div></div><div>Signed</div><div>MP</div></div><div><div><div><div></div><div></div></div><div>Date</div><div>04/11/24</div></div><div><div><div><div></div><div></div></div><div>Suitability Code</div><div>S2</div></div><div><div><div><div></div><div></div></div><div>Revision</div><div>P02</div></div></div></div></div><div><div><div><div><div></div><div></div></div><div>Designed</div><div>MWJV</div></div><div><div><div><div></div><div></div></div><div>Signed</div><div>J.SYMONDS</div></div><div><div><div><div></div><div></div></div><div>Date</div><div>04/11/24</div></div><div><div><div><div></div><div></div></div><div>Scale(s)</div><div>1:5000</div></div></div></div><div><div><div><div><div></div><div></div></div><div>Checked</div><div>M.KYNOCH</div></div><div><div><div><div></div><div></div></div><div>Signed</div><div>MP</div></div><div><div><div><div></div><div></div></div><div>Date</div><div>04/11/24</div></div><div><div><div><div></div><div></div></div><div>Status</div><div>Information</div></div><div><div><div><div></div><div></div></div><div>Approved</div><div>M.PENFOLD</div></div><div><div><div><div></div><div></div></div><div>Signed</div><div>MP</div></div><div><div><div><div></div><div></div></div><div>Date</div><div>04/11/24</div></div><div><div><div><div></div><div></div></div><div>Suitability Code</div><div>S2</div></div><div><div><div><div></div><div></div></div><div>Revision</div><div>P02</div></div></div></div></div><div><div><div><div><div></div><div></div></div><div>Designed</div><div>MWJV</div></div><div><div><div><div></div><div></div></div><div>Signed</div><div>J.SYMONDS</div></div><div><div><div><div></div><div></div></div><div>Date</div><div>04/11/24</div></div><div><div><div><div></div><div></div></div><div>Scale(s)</div><div>1:5000</div></div></div></div><div><div><div><div><div></div><div></div></div><div>Checked</div><div>M.KYNOCH</div></div><div><div><div><div></div><div></div></div><div>Signed</div><div>MP</div></div><div><div><div><div></div><div></div></div><div>Date</div><div>04/11/24</div></div><div><div><div><div></div><div></div></div><div>Status</div><div>Information</div></div><div><div><div><div></div><div></div></div><div>Approved</div><div>M.PENFOLD</div></div><div><div><div><div></div><div></div></div><div>Signed</div><div>MP</div></div><div><div><div><div></div><div></div></div><div>Date</div><div>04/11/24</div></div><div><div><div><div></div><div></div></div><div>Suitability Code</div><div>S2</div></div><div><div><div><div></div><div></div></div><div>Revision</div><div>P02</div></div></div></div></div><div><div><div><div><div></div><div></div></div><div>Designed</div><div>MWJV</div></div><div><div><div><div></div><div></div></div><div>Signed</div><div>J.SYMONDS</div></div><div><div><div><div></div><div></div></div><div>Date</div><div>04/11/24</div></div><div><div><div><div></div><div></div></div><div>Scale(s)</div><div>1:5000</div></div></div></div><div><div><div><div><div></div><div></div></div><div>Checked</div><div>M.KYNOCH</div></div><div><div><div><div></div><div></div></div><div>Signed</div><div>MP</div></div><div><div><div><div></div><div></div></div><div>Date</div><div>04/11/24</div></div><div><div><div><div></div><div></div></div><div>Status</div><div>Information</div></div><div><div><div><div></div><div></div></div><div>Approved</div><div>M.PENFOLD</div></div><div><div><div><div></div><div></div></div><div>Signed</div><div>MP</div></div><div><div><div><div></div><div></div></div><div>Date</div><div>04/11/24</div></div><div><div><div><div></div><div></div></div><div>Suitability Code</div><div>S2</div></div><div><div><div><div></div><div></div></div><div>Revision</div><div>P02</div></div></div></div></div><div><div><div><div><div></div><div></div></div><div>Designed</div><div>MWJV</div></div><div><div><div><div></div><div></div></div><div>Signed</div><div>J.SYMONDS</div></div><div><div><div><div></div><div></div></div><div>Date</div><div>04/11/24</div></div><div><div><div><div></div><div></div></div><div>Scale(s)</div><div>1:5000</div></div></div></div><div><div><div><div><div></div><div></div></div><div>Checked</div><div>M.KYNOCH</div></div><div><div><div><div></div><div></div></div><div>Signed</div><div>MP</div></div><div><div><div><div></div><div></div></div><div>Date</div><div>04/11/24</div></div><div><div><div><div></div><div></div></div><div>Status</div><div>Information</div></div><div><div><div><div></div><div></div></div><div>Approved</div><div>M.PENFOLD</div></div><div><div><div><div></div><div></div></div><div>Signed</div><div>MP</div></div><div><div><div><div></div><div></div></div><div>Date</div><div>04/11/24</div></div><div><div><div><div></div><div></div></div><div>Suitability Code</div><div>S2</div></div><div><div><div><div></div><div></div></div><div>Revision</div><div>P02</div></div></div></div></div><div><div><div><div><div></div><div></div></div><div>Designed</div><div>MWJV</div></div><div><div><div><div></div><div></div></div><div>Signed</div><div>J.SYMONDS</div></div><div><div><div><div></div><div></div></div><div>Date</div><div>04/11/24</div></div><div><div><div><div></div><div></div></div><div>Scale(s)</div><div>1:5000</div></div></div></div><div><div><div><div><div></div><div></div></div><div>Checked</div><div>M.KYNOCH</div></div><div><div><div><div></div><div></div></div><div>Signed</div><div>MP</div></div><div><div><div><div></div><div></div></div><div>Date</div><div>04/11/24</div></div><div><div><div><div></div><div></div></div><div>Status</div><div>Information</div></div><div><div><div><div></div><div></div></div><div>Approved</div><div>M.PENFOLD</div></div><div><div><div><div></div><div></div></div><div>Signed</div><div>MP</div></div><div><div><div><div></div><div></div></div><div>Date</div><div>04/11/24</div></div><div><div><div><div></div><div></div></div><div>Suitability Code</div><div>S2</div></div><div><div><div><div></div><div></div></div><div>Revision</div><div>P02</div></div></div></div></div><div><div><div><div><div></div><div></div></div><div>Designed</div><div>MWJV</div></div><div><div><div><div></div><div></div></div><div>Signed</div><div>J.SYMONDS</div></div><div><div><div><div></div><div></div></div><div>Date</div><div>04/11/24</div></div><div><div><div><div></div><div></div></div><div>Scale(s)</div><div>1:5000</div></div></div></div><div><div><div><div><div></div><div></div></div><div>Checked</div><div>M.KYNOCH</div></div><div><div><div><div></div><div></div></div><div>Signed</div><div>MP</div></div><div><div><div><div></div><div></div></div><div>Date</div><div>04/11/24</div></div><div><div><div><div></div><div></div></div><div>Status</div><div>Information</div></div><div><div><div><div></div><div></div></div><div>Approved</div><div>M.PENFOLD</div></div><div><div><div><div></div><div></div></div><div>Signed</div><div>MP</div></div><div><div><div><div></div><div></div></div><div>Date</div><div>04/11/24</div></div><div><div><div><div></div><div></div></div><div>Suitability Code</div><div>S2</div></div><div><div><div><div></div><div></div></div><div>Revision</div><div>P02</div></div></div></div></div><div><div><div><div><div></div><div></div></div><div>Designed</div><div>MWJV</div></div><div><div><div><div></div><div></div></div><div>Signed</div><div>J.SYMONDS</div></div><div><div><div><div></div><div></div></div><div>Date</div><div>04/11/24</div></div><div><div><div><div></div><div></div></div><div>Scale(s)</div><div>1:5000</div></div></div></div><div><div><div><div><div></div><div></div></div><div>Checked</div><div>M.KYNOCH</div></div><div><div><div><div></div><div></div></div><div>Signed</div><div>MP</div></div><div><div><div><div></div><div></div></div><div>Date</div><div>04/11/24</div></div><div><div><div><div></div><div></div></div><div>Status</div><div>Information</div></div><div><div><div><div></div><div></div></div><div>Approved</div><div>M.PENFOLD</div></div><div><div><div><div></div><div></div></div><div>Signed</div><div>MP</div></div><div><div><div><div></div><div></div></div><div>Date</div><div>04/11/24</div></div><div><div><div><div></div><div></div></div><div>Suitability Code</div><div>S2</div></div><div><div><div><div></div><div></div></div><div>Revision</div><div>P02</div></div></div></div></div><div><div><div><div><div></div><div></div></div><div>Designed</div><div>MWJV</div></div><div><div><div><div></div><div></div></div><div>Signed</div><div>J.SYMONDS</div></div><div><div><div><div></div><div></div></div><div>Date</div><div>04/11/24</div></div><div><div><div><div></div><div></div></div><div>Scale(s)</div><div>1:5000</div></div></div></div><div><div><div><div><div></div><div></div></div><div>Checked</div><div>M.KYNOCH</div></div><div><div><div><div></div><div></div></div><div>Signed</div><div>MP</div></div><div><div><div><div></div><div></div></div><div>Date</div><div>04/11/24</div></div><div><div><div><div></div><div></div></div><div>Status</div><div>Information</div></div><div><div><div><div></div><div></div></div><div>Approved</div><div>M.PENFOLD</div></div><div><div><div><div></div><div></div></div><div>Signed</div><div>MP</div></div><div><div><div><div></div><div></div></div><div>Date</div><div>04/11/24</div></div><div><div><div><div></div><div></div></div><div>Suitability Code</div><div>S2</div></div><div><div><div><div></div><div></div></div><div>Revision</div><div>P02</div></div></div></div></div><div><div><div><div><div></div><div></div></div><div>Designed</div><div>MWJV</div></div><div><div><div><div></div><div></div></div><div>Signed</div><div>J.SYMONDS</div></div><div><div><div><div></div><div></div></div><div>Date</div><div>04/11/24</div></div><div><div><div><div></div><div></div></div><div>Scale(s)</div><div>1:5000</div></div></div></div><div><div><div><div><div></div><div></div></div><div>Checked</div><div>M.KYNOCH</div></div><div><div><div><div></div><div></div></div><div>Signed</div><div>MP</div></div><div><div><div><div></div><div></div></div><div>Date</div><div>04/11/24</div></div><div><div><div><div></div><div></div></div><div>Status</div><div>Information</div></div><div><div><div><div></div><div></div></div><div>Approved</div><div>M.PENFOLD</div></div><div><div><div><div></div><div></div></div><div>Signed</div><div>MP</div></div><div><div><div><div></div><div></div></div><div>Date</div><div>04/11/24</div></div><div><div><div><div></div><div></div></div><div>Suitability Code</div><div>S2</div></div><div><div><div><div></div><div></div></div><div>Revision</div><div>P02</div></div></div></div></div><div><div><div><div><div></div><div></div></div><div>Designed</div><div>MWJV</div></div><div><div><div><div></div><div></div></div><div>Signed</div><div>J.SYMONDS</div></div><div><div><div><div></div><div></div></div><div>Date</div><div>04/11/24</div></div><div><div><div><div></div><div></div></div><div>Scale(s)</div><div>1:5000</div></div></div></div><div><div><div><div><div></div><div></div></div><div>Checked</div><div>M.KYNOCH</div></div><div><div><div><div></div><div></div></div><div>Signed</div><div>MP</div></div><div><div><div><div></div><div></div></div><div>Date</div><div>04/11/24</div></div><div><div><div><div></div><div></div></div><div>Status</div><div>Information</div></div><div><div><div><div></div><div></div></div><div>Approved</div><div>M.PENFOLD</div></div><div><div><div><div></div><div></div></div><div>Signed</div><div>MP</div></div><div><div><div><div></div><div></div></div><div>Date</div><div>04/11/24</div></div><div><div><div><div></div><div></div></div><div>Suitability Code</div><div>S2</div></div><div><div><div><div></div><div></div></div><div>Revision</div><div>P02</div></div></div></div></div><div><div><div><div><div></div><div></div></div><div>Designed</div><div>MWJV</div></div><div><div><div><div></div><div></div></div><div>Signed</div><div>J.SYMONDS</div></div><div><div><div><div></div><div></div></div><div>Date</div><div>04/11/24</div></div><div><div><div><div></div><div></div></div><div>Scale(s)</div><div>1:5000</div></div></div></div><div><div><div><div><div></div><div></div></div><div>Checked</div><div>M.KYNOCH</div></div><div><div><div><div></div><div></div></div><div>Signed</div><div>MP</div></div><div><div><div><div></div><div></div></div><div>Date</div><div>04/11/24</div></div><div><div><div><div></div><div></div></div><div>Status</div><div>Information</div></div><div><div><div><div></div><div></div></div><div>Approved</div><div>M.PENFOLD</div></div><div><div><div><div></div><div></div></div><div>Signed</div><div>MP</div></div><div><div><div><div></div><div></div></div><div>Date</div><div>04/11/24</div></div><div><div><div><div></div><div></div></div><div>Suitability Code</div><div>S2</div></div><div><div><div><div></div><div></div></div><div>Revision</div><div>P02</div></div></div></div></div><div><div><div><div><div></div><div></div></div><div>Designed</div><div>MWJV</div></div><div><div><div><div></div><div></div></div><div>Signed</div><div>J.SYMONDS</div></div><div><div><div><div></div><div></div></div><div>Date</div><div>04/11/24</div></div><div><div><div><div></div><div></div></div><div>Scale(s)</div><div>1:5000</div></div></div></div><div><div><div><div><div></div><div></div></div><div>Checked</div><div>M.KYNOCH</div></div><div><div><div><div></div><div></div></div><div>Signed</div><div>MP</div></div><div><div><div><div></div><div></div></div><div>Date</div><div>04/11/24</div></div><div><div><div><div></div><div></div></div><div>Status</div><div>Information</div></div><div><div><div><div></div><div></div></div><div>Approved</div><div>M.PENFOLD</div></div><div><div><div><div></div><div></div></div><div>Signed</div><div>MP</div></div><div><div><div><div></div><div></div></div><div>Date</div><div>04/11/24</div></div><div><div><div><div></div><div></div></div><div>Suitability Code</div><div>S2</div></div><div><div><div><div></div><div></div></div><div>Revision</div><div>P02</div></div></div></div></div><div><div><div><div><div></div><div></div></div><div>Designed</div><div>MWJV</div></div><div><div><div><div></div><div></div></div><div>Signed</div><div>J.SYMONDS</div></div><div><div><div><div></div><div></div></div><div>Date</div><div>04/11/24</div></div><div><div><div><div></div><div></div></div><div>Scale(s)</div><div>1:5000</div></div></div></div><div><div><div><div><div></div><div></div></div><div>Checked</div><div>M.KYNOCH</div></div><div><div><div><div></div><div></div></div><div>Signed</div><div>MP</div></div><div><div><div><div></div><div></div></div><div>Date</div><div>04/11/24</div></div><div><div><div><div></div><div></div></div><div>Status</div><div>Information</div></div><div><div><div><div></div><div></div></div><div>Approved</div><div>M.PENFOLD</div></div><div><div><div><div></div><div></div></div><div>Signed</div><div>MP</div></div><div><div><div><div></div><div></div></div><div>Date</div><div>04/11/24</div></div><div><div><div><div></div><div></div></div><div>Suitability Code</div><div>S2</div></div><div><div><div><div></div><div></div></div><div>Revision</div><div>P02</div></div></div></div></div><div><div><div><div><div></div><div></div></div><div>Designed</div><div>MWJV</div></div><div><div><div><div></div><div></div></div><div>Signed</div><div>J.SYMONDS</div></div><div><div><div><div></div><div></div></div><div>Date</div><div>04/11/24</div></div><div><div><div><div></div><div></div></div><div>Scale(s)</div><div>1:5000</div></div></div></div><div><div><div><div><div></div><div></div></div><div>Checked</div><div>M.KYNOCH</div></div><div><div><div><div></div><div></div></div><div>Signed</div><div>MP</div></div><div><div><div><div></div><div></div></div><div>Date</div><div>04/11/24</div></div><div><div><div><div></div><div></div></div><div>Status</div><div>Information</div></div><div><div><div><div></div><div></div></div><div>Approved</div><div>M.PENFOLD</div></div><div><div><div><div></div><div></div></div><div>Signed</div><div>MP</div></div><div><div><div><div></div><div></div></div><div>Date</div><div>04/11/24</div></div><div><div><div><div></div><div></div></div><div>Suitability Code</div><div>S2</div></div><div><div><div><div></div><div></div></div><div>Revision</div><div>P02</div></div></div></div></div><div><div><div><div><div></div><div></div></div><div>Designed</div><div>MWJV</div></div><div><div><div><div></div><div></div></div><div>Signed</div><div>J.SYMONDS</div></div><div><div><div><div></div><div></div></div><div>Date</div><div>04/11/24</div></div><div><div><div><div></div><div></div></div><div>Scale(s)</div><div>1:5000</div></div></div></div><div><div><div><div><div></div><div></div></div><div>Checked</div><div>M.KYNOCH</div></div><div><div><div><div></div><div></div></div><div>Signed</div><div>MP</div></div><div><div><div><div></div><div></div></div><div>Date</div><div>04/11/24</div></div><div><div><div><div></div><div></div></div><div>Status</div><div>Information</div></div><div><div><div><div></div><div></div></div><div>Approved</div><div>M.PENFOLD</div></div><div><div><div><div></div><div></div></div><div>Signed</div><div>MP</div></div><div><div><div><div></div><div></div></div><div>Date</div><div>04/11/24</div></div><div><div><div><div></div><div></div></div><div>Suitability Code</div><div>S2</div></div><div><div><div><div></div><div></div></div><div>Revision</div><div>P02</div></div></div></div></div><div><div><div><div><div></div><div></div></div><div>Designed</div><div>MWJV</div></div><div><div><div><div></div><div></div></div><div>Signed</div><div>J.SYMONDS</div></div><div><div><div><div></div><div></div></div><div>Date</div><div>04/11/24</div></div><div><div><div><div></div><div></div></div><div>Scale(s)</div><div>1:5000</div></div></div></div><div><div><div><div><div></div><div></div></div><div>Checked</div><div>M.KYNOCH</div></div><div><div><div><div></div><div></div></div><div>Signed</div><div>MP</div></div><div><div><div><div></div><div></div></div><div>Date</div><div>04/11/24</div></div><div><div><div><div></div><div></div></div><div>Status</div><div>Information</div></div><div><div><div><div></div><div></div></div><div>Approved</div><div>M.PENFOLD</div></div><div><div><div><div></div><div></div></div><div>Signed</div><div>MP</div></div><div><div><div><div></div><div></div></div><div>Date</div><div>04/11/24</div></div><div><div><div><div></div><div></div></div><div>Suitability Code</div><div>S2</div></div><div><div><div><div></div><div></div></div><div>Revision</div><div>P02</div></div></div></div></div><div><div><div><div><div></div><div></div></div><div>Designed</div><div>MWJV</div></div><div><div><div><div></div><div></div></div><div>Signed</div><div>J.SYMONDS</div></div><div><div><div><div></div><div></div></div><div>Date</div><div>04/11/24</div></div><div><div><div><div></div><div></div></div><div>Scale(s)</div><div>1:5000</div></div></div></div><div><div><div><div><div></div><div></div></div><div>Checked</div><div>M.KYNOCH</div></div><div><div><div><div></div><div></div></div><div>Signed</div><div>MP</div></div><div><div><div><div></div><div></div></div><div>Date</div><div>04/11/24</div></div><div><div><div><div></div><div></div></div><div>Status</div><div>Information</div></div><div><div><div><div></div><div></div></div><div>Approved</div><div>M.PENFOLD</div></div><div><div><div><div></div><div></div></div><div>Signed</div><div>MP</div></div><div><div><div><div></div><div></div></div><div>Date</div><div>04/11/24</div></div><div><div><div><div></div><div></div></div><div>Suitability Code</div><div>S2</div></div><div><div><div><div></div><div></div></div><div>Revision</div><div>P02</div></div></div></div></div><div><div><div><div><div></div><div></div></div><div>Designed</div><div>MWJV</div></div><div><div><div><div></div><div></div></div><div>Signed</div><div>J.SYMONDS</div></div><div><div><div><div></div><div></div></div><div>Date</div><div>04/11/24</div></div><div><div><div><div></div><div></div></div><div>Scale(s)</div><div>1:5000</div></div></div></div><div><div><div><div><div></div><div></div></div><div>Checked</div><div>M.KYNOCH</div></div><div><div><div><div></div><div></div></div><div>Signed</div><div>MP</div></div><div><div><div><div></div><div></div></div><div>Date</div><div>04/11/24</div></div><div><div><div><div></div><div></div></div><div>Status</div><div>Information</div></div><div><div><div><div></div><div></div></div><div>Approved</div><div>M.PENFOLD</div></div><div><div><div><div></div><div></div></div><div>Signed</div><div>MP</div></div><div><div><div><div></div><div></div></div><div>Date</div><div>04/11/24</div></div><div><div><div><div></div><div></div></div><div>Suitability Code</div><div>S2</div></div><div><div><div><div></div><div></div></div><div>Revision</div><div>P02</div></div></div></div></div><div><div><div><div><div></div><div></div></div><div>Designed</div><div>MWJV</div></div><div><div><div><div></div><div></div></div><div>Signed</div><div>J.SYMONDS</div></div><div><div><div><div></div><div></div></div><div>Date</div><div>04/11/24</div></div><div><div><div><div></div><div></div></div><div>Scale(s)</div><div>1:5000</div></div></div></div><div><div><div><div><div></div><div></div></div><div>Checked</div><div>M.KYNOCH</div></div><div><div><div><div></div><div></div></div><div>Signed</div><div>MP</div></div><div><div><div><div></div><div></div></div><div>Date</div><div>04/11/24</div></div><div><div><div><div></div><div></div></div><div>Status</div><div>Information</div></div><div><div><div><div></div><div></div></div><div>Approved</div><div>M.PENFOLD</div></div><div><div><div><div></div><div></div></div><div>Signed</div><div>MP</div></div><div><div><div><div></div><div></div></div><div>Date</div><div>04/11/24</div></div><div><div><div><div></div><div></div></div><div>Suitability Code</div><div>S2</div></div><div><div><div><div></div><div></div></div><div>Revision</div><div>P02</div></div></div></div></div><div><div><div><div><div></div><div></div></div><div>Designed</div><div>MWJV</div></div><div><div><div><div></div><div></div></div><div>Signed</div><div>J.SYMONDS</div></div><div><div><div><div></div><div></div></div><div>Date</div><div>04/11/24</div></div><div><div><div><div></div><div></div></div><div>Scale(s)</div><div>1:5000</div></div></div></div><div><div><div><div><div></div><div></div></div><div>Checked</div><div>M.KYNOCH</div></div><div><div><div><div></div><div></div></div><div>Signed</div><div>MP</div></div><div><div><div><div></div><div></div></div><div>Date</div><div>04/11/24</div></div><div><div><div><div></div><div></div></div><div>Status</div><div>Information</div></div><div><div><div><div></div><div></div></div><div>Approved</div><div>M.PENFOLD</div></div><div><div><div><div></div><div></div></div><div>Signed</div><div>MP</div></div><div><div><div><div></div><div></div></div><div>Date</div><div>04/11/24</div></div><div><div><div><div></div><div></div></div><div>Suitability Code</div><div>S2</div></div><div><div><div><div></div><div></</div></div></div></div></div></div></div></div></div></div></div></div></div></div></div></div></div></div></div></div></div></div></div></div></div></div></div></div></div></div></div></div></div></div></div></div></div></div></div></div></div></div></div></div></div></div></div></div></div></div></div></div></div></div></div></div></div></div></div></div></div></div></div></div></div></div></div></div></div></div></div></div></div></div></div></div></div></div></div></div></div></div></div></div></div></div></div></div></div></div></div></div></div></div></div></div></div></div></div></div></div></div></div></div></div></div></div></div></div></div></div></div></div></div></div></div></div></div></div></div></div></div></div></div></div></div></div></div></div></div></div></div></div></div></div></div></div></div></div></div></div></div></div></div></div></div></div></div></div></div></div></div></div></div></div></div></div></div></div></div></div></div></div></div></div></div></div></div></div></div></div></div></div></div></div></div></div></div></div></div></div></div></div></div></div></div></div></div></div></div></div></div></div></div></div></div></div></div></div></div></div></div></div></div></div></div></div></div></div></div></div></div></div></div></div></div></div></div></div></div></div></div></div></div></div></div></div></div></div></div></div></div></div></div></div></div></div></div></div></div></div></div></div></div></div></div></div></div></div></div></div></div></div></div></div></div></div></div>								

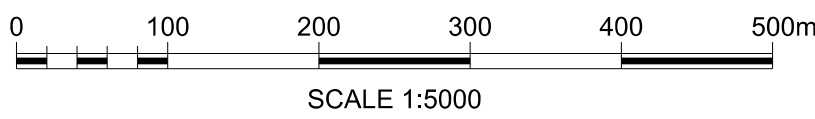
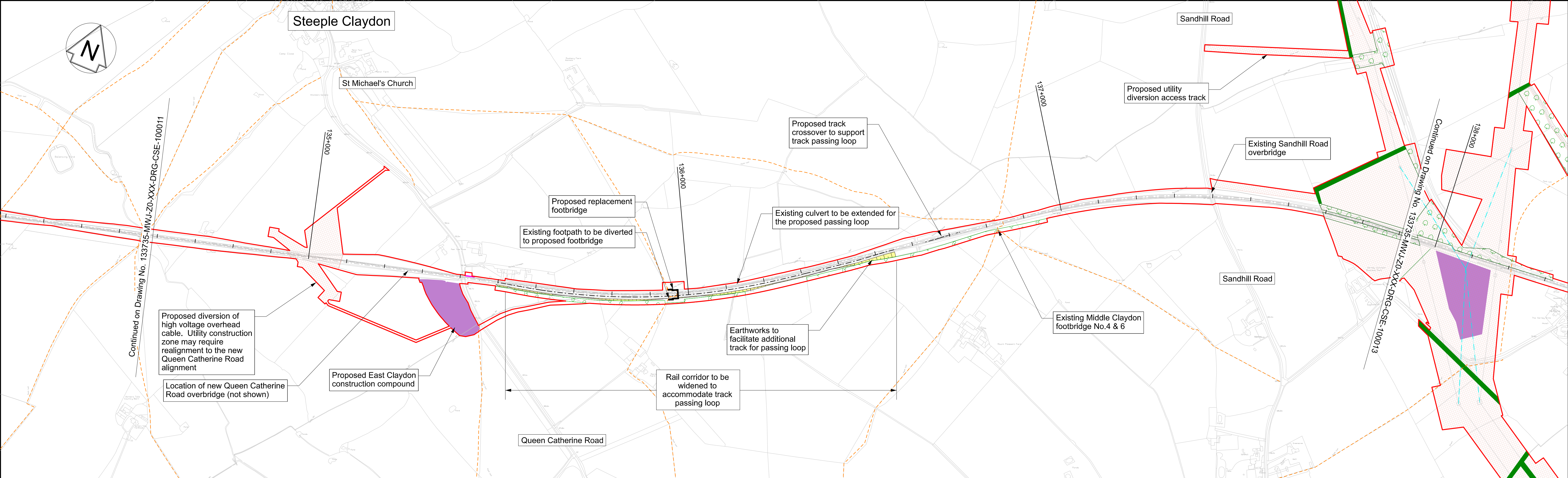

PLAN
SCALE 1:5000 @ A1

Profile Legend:
--- EWR vertical alignment
--- Existing vertical alignment
--- Existing ground

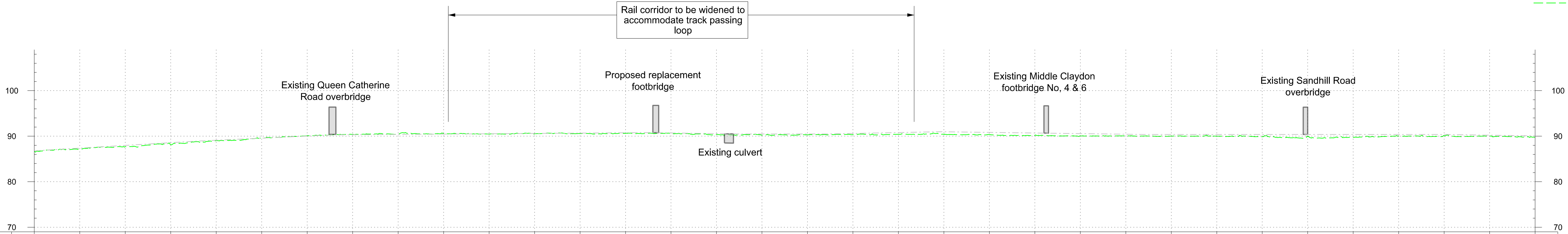

DOWN MAIN	CHAINAGE	134+600	134+700	134+800	134+900	135+000	135+100	135+200	135+300	135+400	135+500	135+600	135+700	135+800	135+900	136+000	136+100	136+200	136+300	136+400	136+500	136+600	136+700	136+800	136+900	137+000	137+100	137+200	137+300	137+400	137+500	137+600	137+700	137+800	137+900
	EXISTING LEVEL	86.6	87.2	87.7	88.1	89.0	89.6	90.1	90.4	90.5	90.6	90.4	90.5	90.6	90.6	90.6	90.4	90.2	90.3	90.3	90.4	90.4	90.4	90.2	90.1	90.1	90.0	90.0	89.9	89.9	89.7	90.0	90.1	90.0	89.8
	PROPOSED LEVEL	SAME AS EXISTING															SAME AS EXISTING																		
	DIFFERENCE	SAME AS EXISTING															SAME AS EXISTING																		

PROFILE
SCALE H:1:5000 V:1:500 @ A1

OS map data reproduced by permission of Ordnance Survey on behalf of HMSO. © Crown copyright 2021. All rights reserved. Ordnance Survey licence number AC0000830606
This document is issued for the party which commissioned it and for specific purposes connected with the captioned project only. It should not be relied upon by any other party or used for any other purpose.
We accept no responsibility for the consequences of this document being relied upon by any other party, or being used for any other purpose, or containing any error or omission in data supplied to us by other parties.

These drawings are indicative and for consultation purposes only
For guidance and general notes refer to drawing 133735-MWJ-Z0-XXX-DRG-CSE-000002

Legend/Notes

- Draft Order Limits
- EWR alignment
- Chainage (metres)
- Permanent highway (public and private)
- EWR existing alignment (by others)
- Construction zone (by others)
- Engineering earthworks (embankment)
- Engineering earthworks (cutting)
- Landscape mitigation earthworks (embankment)
- Landscape mitigation earthworks (cutting)
- Construction & logistic sites
- Telecoms compound
- Traction power compound
- Bridges and retaining walls
- Noise mitigation (indicative)
- Station or other building
- Utilities construction zone
- Habitat creation - woodland
- Habitat creation - hedgerow
- Habitat creation - scrub
- Habitat creation - grassland
- Habitat creation - wetland
- Public realm / station car parking
- Public Right of Way - existing
- Public Right of Way - closed
- Public Right of Way - proposed
- Balancing pond (indicative)
- Drainage attenuation tank (below ground)
- Preliminary utilities diversion

Project
East West Rail
Oxford to Cambridge

Drawing Title
DCO Non-Statutory Consultation
Oxford to Bletchley
Route Section 1
Sheet 12

east west RAIL

One Grafton Mews, Midsummer Boulevard, Milton Keynes, Buckinghamshire, MK9 1FB

Designed MWJV	Signed JS	Date 04/11/24	Checked M.KYNOCH	Signed MK	Date 04/11/24
Drawn J.SYMONDS	Signed JS	Date 04/11/24	Approved M.PENFOLD	Signed MP	Date 04/11/24
Scale(s) 1:5000	Status Information	Suitability Code S2		Revision 12 of 76	
Drawing Number 133735-MWJ-Z0-XXX-DRG-CSE-100012				Revision P02	

Molt MacDonald House, 8-10 Sydenham Road, Croydon, CR20 2EE.
WSP House, Chancery Lane, London, WC2A 1AF.

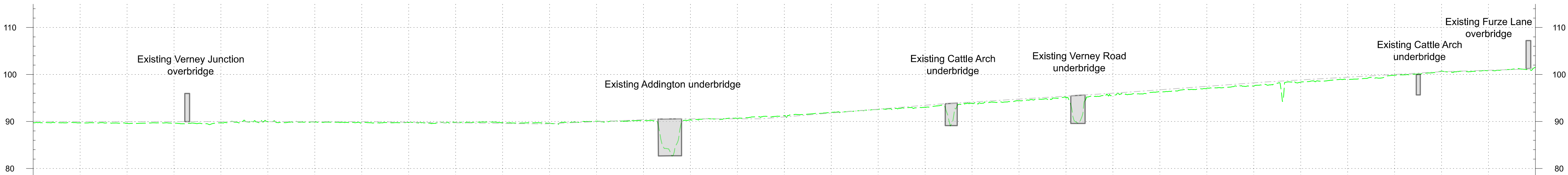
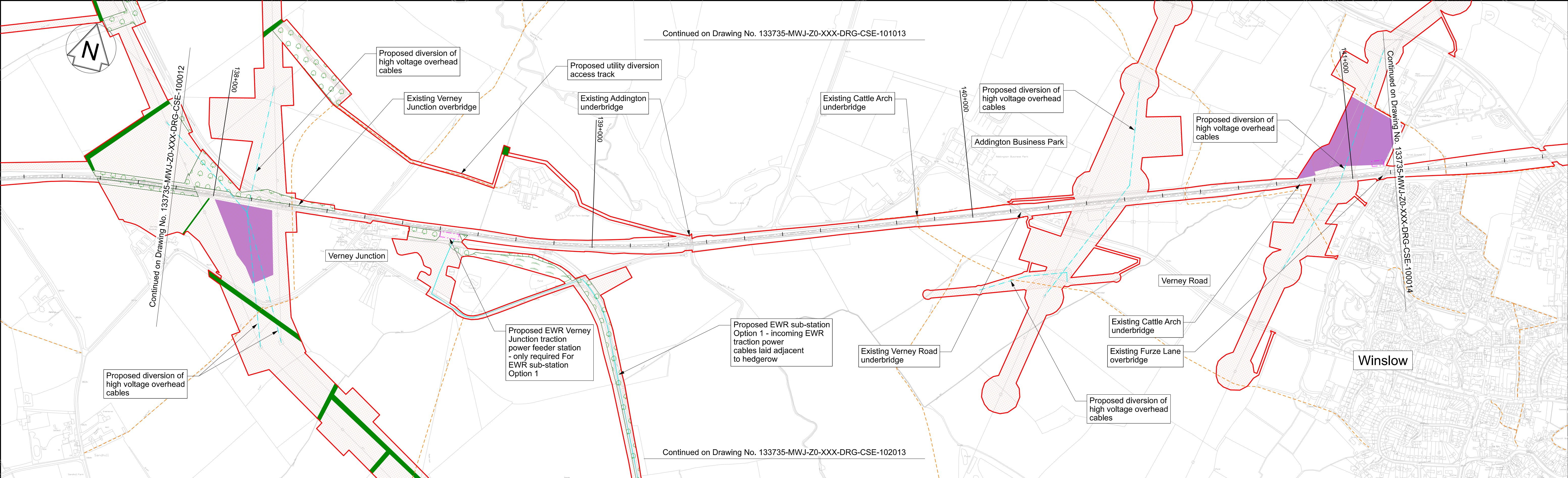

DOWN MAIN	CHAINAGE	137+900	138+000	138+100	138+200	138+300	138+400	138+500	138+600	138+700	138+800	138+900	139+000	139+100	139+200	139+300	139+400	139+500	139+600	139+700	139+800	139+900	140+000	140+100	140+200	140+300	140+400	140+500	140+600	140+700	140+800	140+900	141+000	141+100																							
	EXISTING LEVEL	89.8	89.7	89.6	89.7	89.7	90.0	89.9	89.8	89.8	89.8	89.7	89.6	90.1	90.2	90.3	90.7	91.2	92.0	92.6	93.0	93.8	94.4	95.0	95.6	96.4	97.1	97.6	98.4	98.9	99.8	100.7	100.8	101.5																							
	PROPOSED LEVEL	SAME AS EXISTING																												SAME AS EXISTING																											
	DIFFERENCE	SAME AS EXISTING																												SAME AS EXISTING																											

PROFILE

SCALE H:1:5000 V:1:500 @ A1

OS map data reproduced by permission of Ordnance Survey on behalf of HMSO. © Crown copyright 2021. All rights reserved. Ordnance Survey licence number AC0000830608

This document is issued for the party which commissioned it and for specific purposes connected with the captioned project only. It should not be relied upon by any other party or used for any other purpose.

We accept no responsibility for the consequences of this document being relied upon by any other party, or being used for any other purpose, or containing any error or omission which is due to an error or omission in data supplied to us by other parties.

These drawings are indicative and for consultation purposes only

For guidance and general notes refer to drawing 133735-MWJ-Z0-XXX-DRG-CSE-000002

Legend/Notes				Project			
<ul style="list-style-type: none">Draft Order LimitsEWR alignmentChainage (metres)Permanent highway (public and private)EWR existing alignment (by others)Construction zone (by others)				East West Rail Oxford to Cambridge			
<ul style="list-style-type: none">Engineering earthworks (embankment)Engineering earthworks (cutting)Landscape mitigation earthworks (embankment)Landscape mitigation earthworks (cutting)				DCO Non-Statutory Consultation Oxford to Bletchley Route Section 1 Sheet 13			
<ul style="list-style-type: none">Construction & logistic sitesTelecoms compoundTraction power compoundBridges and retaining wallsNoise mitigation (indicative)Station or other buildingUtilities construction zone				east west RAIL One Grafton Mews, Midsummer Boulevard, Milton Keynes, Buckinghamshire, MK9 1FB			
<ul style="list-style-type: none">Habitat creation - woodlandHabitat creation - hedgerowHabitat creation - scrubHabitat creation - grasslandHabitat creation - wetlandPublic realm / station car parking				Designated J.SYMONDS Scale(s) 1:5000			
<ul style="list-style-type: none">Public Right of Way - existingPublic Right of Way - closedPublic Right of Way - proposedBalancing pond (indicative)Drainage attenuation tank (below ground)Preliminary utilities diversion				Signed J.SYMONDS Status Information			
				Checked M.KYNOCH Approved M.PENFOLD			
				Signed MK Date 04/11/24			
				Signed MP Date 04/11/24			
				Suitability Code S2			
				Revision 13 of 76			
				Revision P02			
				Drawing Number 133735-MWJ-Z0-XXX-DRG-CSE-100013			

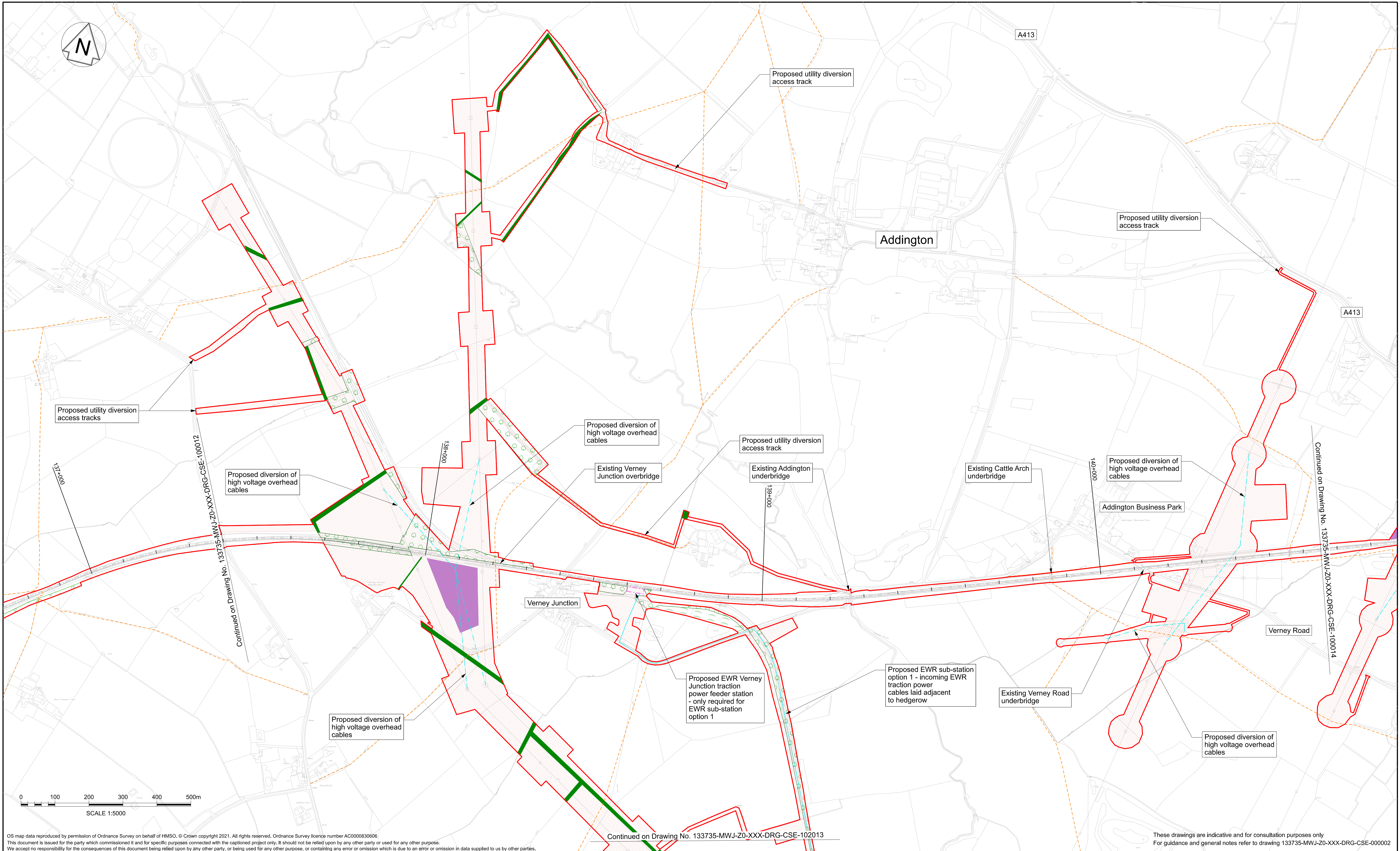

OS map data reproduced by permission of Ordnance Survey on behalf of HMSO. © Crown copyright 2021. All rights reserved. Ordnance Survey licence number AC0000830606
This document is issued for the party which commissioned it and for specific purposes connected with the captioned project only. It should not be relied upon by any other party or used for any other purpose.
We accept no responsibility for the consequences of this document being relied upon by any other party, or being used for any other purpose, or containing any error or omission in data supplied to us by other parties.

Continued on Drawing No. 133735-MWJ-Z0-XXX-DRG-CSE-100012

Continued on Drawing No. 133735-MWJ-Z0-XXX-DRG-CSE-100014

Continued on Drawing No. 133735-MWJ-Z0-XXX-DRG-CSE-102013

These drawings are indicative and for consultation purposes only
For guidance and general notes refer to drawing 133735-MWJ-Z0-XXX-DRG-CSE-000002

Legend/Notes

<ul style="list-style-type: none">Draft Order LimitsEWR alignmentChainage (metres)Permanent highway (public and private)EWR existing alignment (by others)Construction zone (by others)	<ul style="list-style-type: none">Engineering earthworks (embankment)Engineering earthworks (cutting)Landscape mitigation earthworks (embankment)Landscape mitigation earthworks (cutting)	<ul style="list-style-type: none">Construction & logistic sitesTelecoms compoundTraction power compoundBridges and retaining wallsNoise mitigation (indicative)Station or other buildingUtilities construction zone	<ul style="list-style-type: none">Habitat creation - woodlandHabitat creation - hedgerowHabitat creation - scrubHabitat creation - grasslandHabitat creation - wetlandPublic realm / station car parking	<ul style="list-style-type: none">Public Right of Way - existingPublic Right of Way - closedPublic Right of Way - proposedBalancing pond (indicative)Drainage attenuation tank (below ground)Preliminary utilities diversion
--	---	---	---	---

Project
East West Rail
Oxford to Cambridge

Drawing Title
DCO Non-Statutory Consultation
Oxford to Bletchley
Route Section 1
Sheet 13a

east west RAIL

One Grafton Mews, Midsummer Boulevard, Milton Keynes, Buckinghamshire, MK9 1FB

Designed MWJV	Signed JS	Date 04/11/24	Checked M.KYNOCH	Signed MK	Date 04/11/24
Drawn J.SYMONDS	Signed JS	Date 04/11/24	Approved M.PENFOLD	Signed MP	Date 04/11/24
Scale(s) 1:5000	Status Information			Suitability Code S2	Sheet 20 of 76
Drawing Number 133735-MWJ-Z0-XXX-DRG-CSE-101013				Revision P02	

Molt MacDonald House, 8-10 Sydenham Road, Croydon, CR20 2EE.
WSP House, Chancery Lane, London, WC2A 1AF.

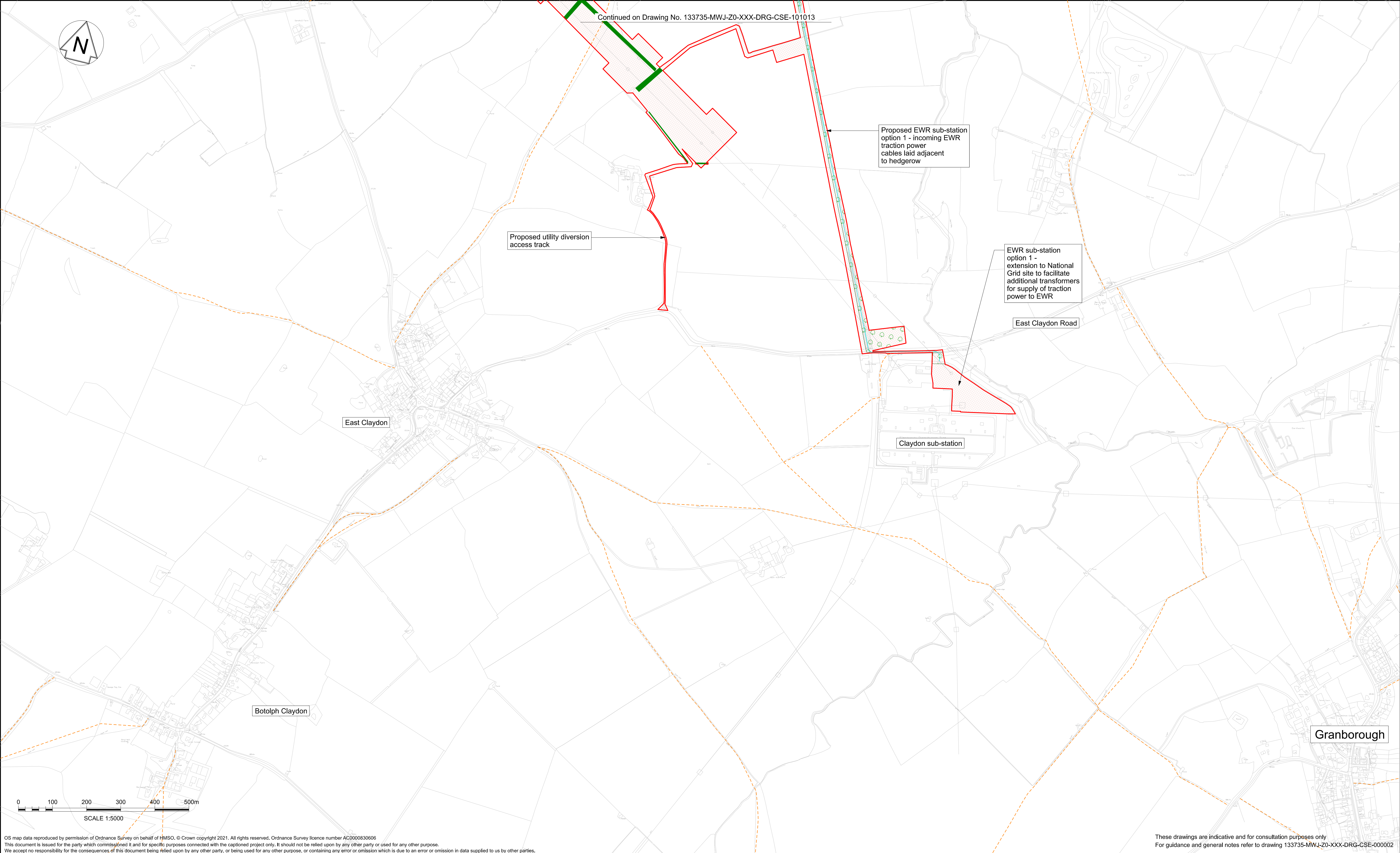

OS map data reproduced by permission of Ordnance Survey on behalf of HMSO. © Crown copyright 2021. All rights reserved. Ordnance Survey licence number AC0000830608
This document is issued for the party which commissioned it and for specific purposes connected with the captioned project only. It should not be relied upon by any other party or used for any other purpose.
We accept no responsibility for the consequences of this document being relied upon by any other party, or being used for any other purpose, or containing any error or omission which is due to an error or omission in data supplied to us by other parties.

These drawings are indicative and for consultation purposes only
For guidance and general notes refer to drawing 133735-MWJ-Z0-XXX-DRG-CSE-000002

										<div>Legend/Notes</div> <div><div><div><div><div></div><div>Draft Order Limits</div></div><div><div></div><div>EWR alignment</div></div><div><div>100=000</div><div>Chainage (metres)</div></div><div><div></div><div>Permanent highway (public and private)</div></div><div><div></div><div>EWR existing alignment (by others)</div></div><div><div></div><div>Construction zone (by others)</div></div></div><div><div><div><div></div><div>Engineering earthworks (embankment)</div></div><div><div></div><div>Engineering earthworks (cutting)</div></div><div><div></div><div>Landscape mitigation earthworks (embankment)</div></div><div><div></div><div>Landscape mitigation earthworks (cutting)</div></div></div><div><div><div><div></div><div>Construction & logistic sites</div></div><div><div></div><div>Telecoms compound</div></div><div><div></div><div>Traction power compound</div></div><div><div></div><div>Bridges and retaining walls</div></div><div><div></div><div>Noise mitigation (indicative)</div></div><div><div></div><div>Station or other building</div></div><div><div></div><div>Utilities construction zone</div></div></div></div></div></div></div>										<div><div><div><div></div><div>Habitat creation - woodland</div></div><div><div></div><div>Habitat creation - hedgerow</div></div><div><div></div><div>Habitat creation - scrub</div></div><div><div></div><div>Habitat creation - grassland</div></div><div><div></div><div>Habitat creation - wetland</div></div><div><div></div><div>Public realm / station car parking</div></div></div><div><div><div><div></div><div>Public Right of Way - existing</div></div><div><div></div><div>Public Right of Way - closed</div></div><div><div></div><div>Public Right of Way - proposed</div></div><div><div></div><div>Balancing pond (indicative)</div></div><div><div></div><div>Drainage attenuation tank (below ground)</div></div><div><div></div><div>Preliminary utilities diversion</div></div></div></div></div>																																																	
										<div>Project</div> <div>East West Rail</div> <div>Oxford to Cambridge</div> <div>Drawing Title</div> <div>DCO Non-Statutory Consultation</div> <div>Oxford to Bletchley</div> <div>Route Section 1</div> <div>Sheet 13b</div>										<div><div><div><div><div>east</div><div>west</div><div>RAIL</div></div></div><div><div><div>One Grafton Mews, Midsummer Boulevard, Milton Keynes, Buckinghamshire, MK9 1FB</div><div>Mott MacDonald House, 8-10 Sydenham Road, Croydon, CR20 2EE, WSP House, Chancery Lane, London, WC2A 1AF.</div></div></div></div><table><tr><td>Designed</td><td>MWJV</td><td>Signed</td><td>Date</td><td>Checked</td><td>M.KYNOCH</td><td>Signed</td><td>MK</td><td>Date</td><td>04/11/24</td></tr><tr><td>Drawn</td><td>J.SYMONDS</td><td>Signed</td><td>JS</td><td>Date</td><td>04/11/24</td><td>Approved</td><td>M.PENFOLD</td><td>Signed</td><td>MP</td></tr><tr><td>Scale(s)</td><td>1:5000</td><td>Status</td><td>Information</td><td>Suitability Code</td><td>S2</td><td>Revision</td><td>23</td><td>of 76</td><td>Sheet</td></tr><tr><td>Drawing Number</td><td colspan="7">133735-MWJ-Z0-XXX-DRG-CSE-102013</td><td>P02</td><td></td></tr></table></div>										Designed	MWJV	Signed	Date	Checked	M.KYNOCH	Signed	MK	Date	04/11/24	Drawn	J.SYMONDS	Signed	JS	Date	04/11/24	Approved	M.PENFOLD	Signed	MP	Scale(s)	1:5000	Status	Information	Suitability Code	S2	Revision	23	of 76	Sheet	Drawing Number	133735-MWJ-Z0-XXX-DRG-CSE-102013							P02	
Designed	MWJV	Signed	Date	Checked	M.KYNOCH	Signed	MK	Date	04/11/24																																																												
Drawn	J.SYMONDS	Signed	JS	Date	04/11/24	Approved	M.PENFOLD	Signed	MP																																																												
Scale(s)	1:5000	Status	Information	Suitability Code	S2	Revision	23	of 76	Sheet																																																												
Drawing Number	133735-MWJ-Z0-XXX-DRG-CSE-102013							P02																																																													

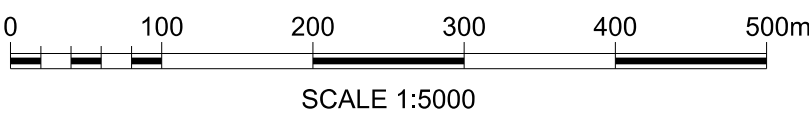
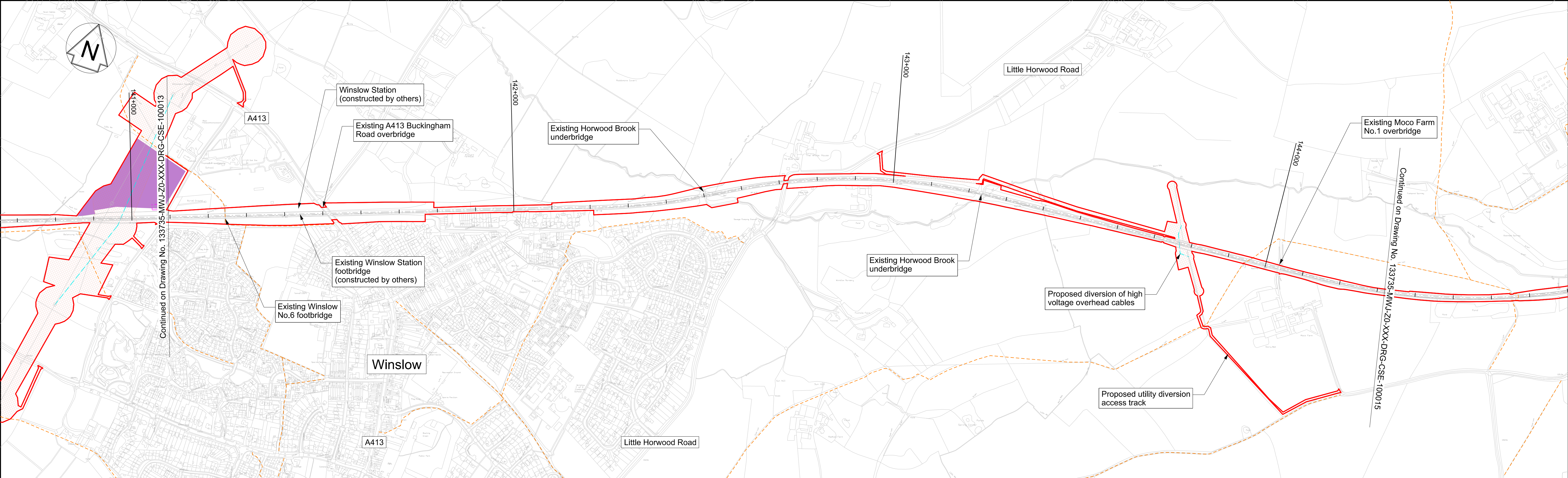

PLAN
SCALE 1:5000 @ A1

- Profile Legend:
- EWR vertical alignment
 - - - Existing vertical alignment
 - Existing ground

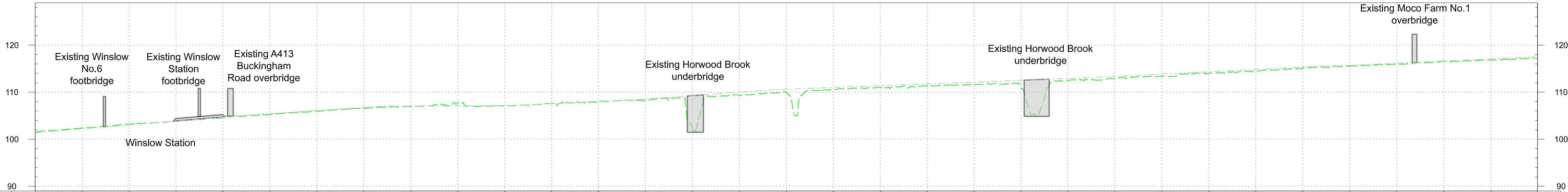

DOWN MAIN	CHAINAGE	141+100	141+200	141+300	141+400	141+500	141+600	141+700	141+800	141+900	142+000	142+100	142+200	142+300	142+400	142+500	142+600	142+700	142+800	142+900	143+000	143+100	143+200	143+300	143+400	143+500	143+600	143+700	143+800	143+900	144+000	144+100	144+200	144+300
	EXISTING LEVEL	101.5	102.4	103.2	103.9	104.6	105.3	106.0	106.6	107.0	107.7	107.1	107.6	108.1	108.3	102.2	109.4	110.0	110.5	111.0	111.4	111.6	111.1	112.5	112.9	113.4	114.0	114.5	115.1	115.5	116.0	116.6	116.9	117.2
	PROPOSED LEVEL	SAME AS EXISTING															SAME AS EXISTING																	
	DIFFERENCE	SAME AS EXISTING															SAME AS EXISTING																	

PROFILE
SCALE H:1:5000 V:1:500 @ A1

OS map data reproduced by permission of Ordnance Survey on behalf of HMSO. © Crown copyright 2021. All rights reserved. Ordnance Survey licence number AC0000830608
This document is issued for the party which commissioned it and for specific purposes connected with the captioned project only. It should not be relied upon by any other party or used for any other purpose.
We accept no responsibility for the consequences of this document being relied upon by any other party, or being used for any other purpose, or containing any error or omission which is due to an error or omission in data supplied to us by other parties.

Legend/Notes

- Draft Order Limits
- EWR alignment
- Chainage (metres)
- Permanent highway (public and private)
- EWR existing alignment (by others)
- Construction zone (by others)

- Engineering earthworks (embankment)
- Engineering earthworks (cutting)
- Landscape mitigation earthworks (embankment)
- Landscape mitigation earthworks (cutting)

- Construction & logistic sites
- Telecoms compound
- Traction power compound
- Bridges and retaining walls
- Noise mitigation (indicative)
- Station or other building
- Utilities construction zone

- Habitat creation - woodland
- Habitat creation - hedgerow
- Habitat creation - scrub
- Habitat creation - grassland
- Habitat creation - wetland
- Public realm / station car parking

- Public Right of Way - existing
- Public Right of Way - closed
- Public Right of Way - proposed
- Balancing pond (indicative)
- Drainage attenuation tank (below ground)
- Preliminary utilities diversion

Project

East West Rail
Oxford to Cambridge

Drawing Title

DCO Non-Statutory Consultation
Oxford to Bletchley
Route Section 1
Sheet 14

These drawings are indicative and for consultation purposes only
For guidance and general notes refer to drawing 133735-MWJ-Z0-XXX-DRG-CSE-000002

One Grafton Mews, Midsummer Boulevard, Milton Keynes, Buckinghamshire, MK9 1FB

Molt MacDonald House, 8-10 Sydenham Road, Croydon, CR20 2EE, WSP House, Chancery Lane, London, WC2A 1AF.

Designed	MWJV	Signed		Date		Checked	M.KYNOCH	Signed	MK	Date	04/11/24
Drawn	J.SYMONDS	Signed	JS	Date	04/11/24	Approved	M.PENFOLD	Signed	MP	Date	04/11/24
Scale(s)	1:5000	Status	Information					Suitability Code	S2	Sheet	14 of 76
Drawing Number	133735-MWJ-Z0-XXX-DRG-CSE-100014									Revision	P02

east west RAIL

Molt MacDonald House, 8-10 Sydenham Road, Croydon, CR20 2EE, WSP House, Chancery Lane, London, WC2A 1AF.

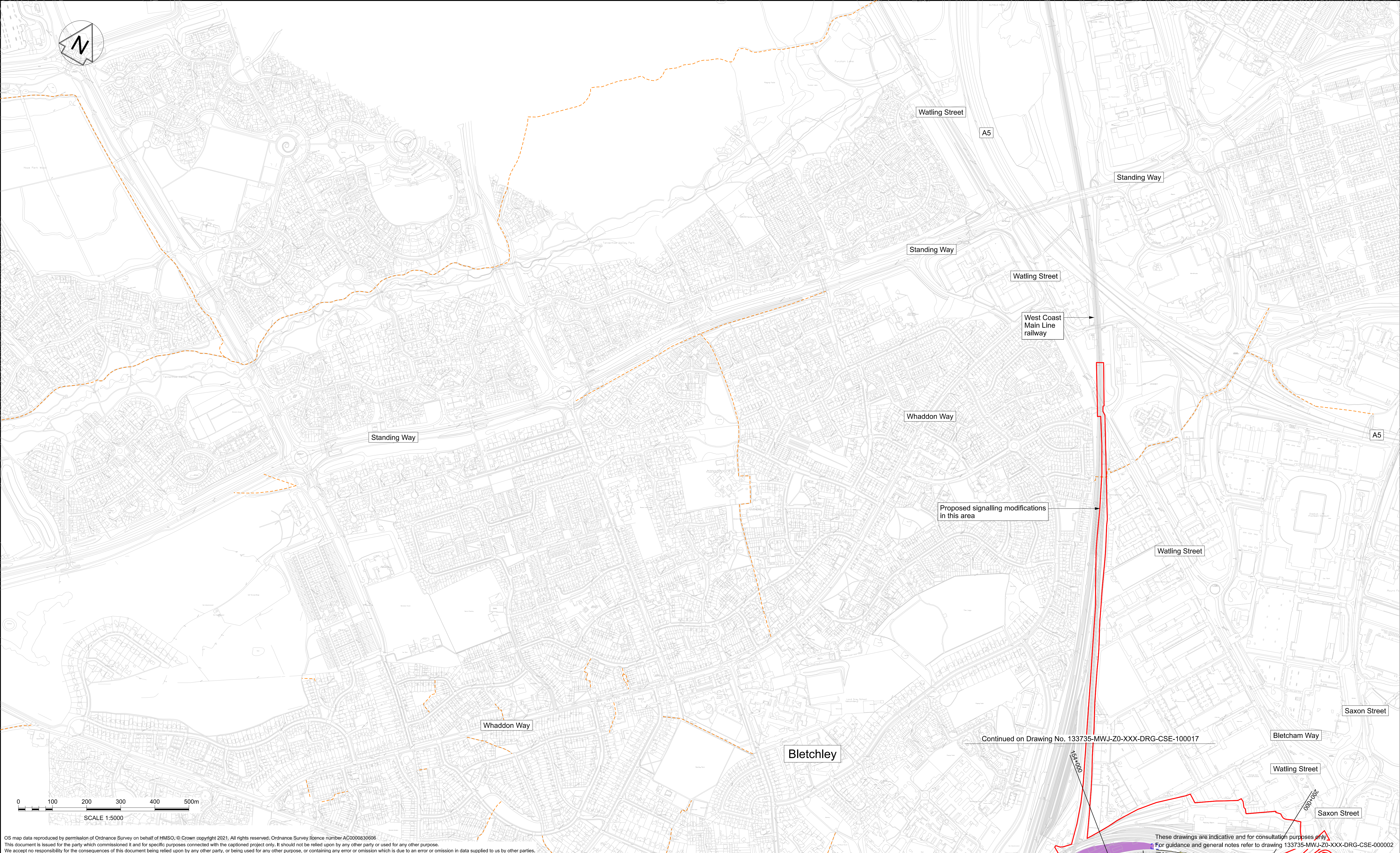

OS map data reproduced by permission of Ordnance Survey on behalf of HMSO. © Crown copyright 2021. All rights reserved. Ordnance Survey licence number AC0000830606.
This document is issued for the party which commissioned it and for specific purposes connected with the captioned project only. It should not be relied upon by any other party or used for any other purpose.
We accept no responsibility for the consequences of this document being relied upon by any other party, or being used for any other purpose, or containing any error or omission which is due to an error or omission in data supplied to us by other parties.

Revision				Description of Revisions			
P01	10/06/24	Prepared for Information	JS	MP			
P02	04/11/24	Prepared for Non-Statutory Consultation	JS	MB	MP		
Rev	Date		Drawn	Chkd	Appr		

- Legend/Notes**
- Draft Order Limits
 - EWR alignment
 - Chainage (metres)
 - Permanent highway (public and private)
 - EWR existing alignment (by others)
 - Construction zone (by others)

- Engineering earthworks (embankment)
- Engineering earthworks (cutting)
- Landscape mitigation earthworks (embankment)
- Landscape mitigation earthworks (cutting)

- Construction & logistic sites
- Telecoms compound
- Traction power compound
- Bridges and retaining walls
- Noise mitigation (indicative)
- Station or other building
- Utilities construction zone

- Habitat creation - woodland
- Habitat creation - hedgerow
- Habitat creation - scrub
- Habitat creation - grassland
- Habitat creation - wetland
- Public realm / station car parking

- Public Right of Way - existing
- Public Right of Way - closed
- Public Right of Way - proposed
- Balancing pond (indicative)
- Drainage attenuation tank (below ground)
- Preliminary utilities diversion

Project

East West Rail
Oxford to Cambridge

Drawing Title

DCO Non-Statutory Consultation
Oxford to Bletchley
Route Section 1
Sheet 17a

One Grafton Mews, Midsummer Boulevard, Milton Keynes, Buckinghamshire, MK9 1FB

Molt MacDonald House, 8-10 Sydenham Road, Croydon, CR20 2EE, WSP House, Chancery Lane, London, WC2A 1AF

Designed	MWJV	Signed		Date		Checked	M.KYNOCH	Signed	MK	Date	04/11/24
Drawn	J.SYMONDS	Signed	JS	Date	04/11/24	Approved	M.PENFOLD	Signed	MP	Date	04/11/24
Scale(s)	1:5000	Status	Information	Suitability Code	S2	Sheet	21	of 76			
Drawing Number	133735-MWJ-Z0-XXX-DRG-CSE-101017								Revision	P02	

These drawings are indicative and for consultation purposes only.
For guidance and general notes refer to drawing 133735-MWJ-Z0-XXX-DRG-CSE-000002